

PROJECT ID: 7323-00-71
WITH: N/A

COUNTY: LA CROSSE

ORDER OF SHEETS

Section No.	1	Title
Section No.	2	Typical Sections and Details
Section No.	3	Estimate of Quantities
Section No.	3	Miscellaneous Quantities
Section No.	4	Right of Way Plat
Section No.	5	Plan and Profile
Section No.	6	Standard Detail Drawings
Section No.	7	Sign Plates
Section No.	8	Structure Plans
Section No.	9	Computer Earthwork Data
Section No.	9	Cross Sections

TOTAL SHEETS =



DESIGN DESIGNATION 7323-00-71

A.A.D.T.	2024	=	2051
A.A.D.T.	2044	=	2266
D.H.V.		=	
D.D.		=	
T.		=	17.4%
DESIGN SPEED		=	45 MPH
ESALS		=	518,300

CONVENTIONAL SYMBOLS

PLAN	
CORPORATE LIMITS	
PROPERTY LINE	
LOT LINE	
LIMITED HIGHWAY EASEMENT	
EXISTING RIGHT OF WAY	
PROPOSED OR NEW R/W LINE	
SLOPE INTERCEPT	
REFERENCE LINE	
EXISTING CULVERT	
PROPOSED CULVERT (Box or Pipe)	
COMBUSTIBLE FLUIDS	
MARSH AREA	
WOODED OR SHRUB AREA	

PROFILE	
GRADE LINE	
ORIGINAL GROUND	
MARSH OR ROCK PROFILE (To be noted as such)	
SPECIAL DITCH	
GRADE ELEVATION	
CULVERT (Profile View)	
UTILITIES	
ELECTRIC	
FIBER OPTIC	
GAS	
SANITARY SEWER	
STORM SEWER	
TELEPHONE	
WATER	
UTILITY PEDESTAL	
POWER POLE	
TELEPHONE POLE	

STRUCTURE B-32-245

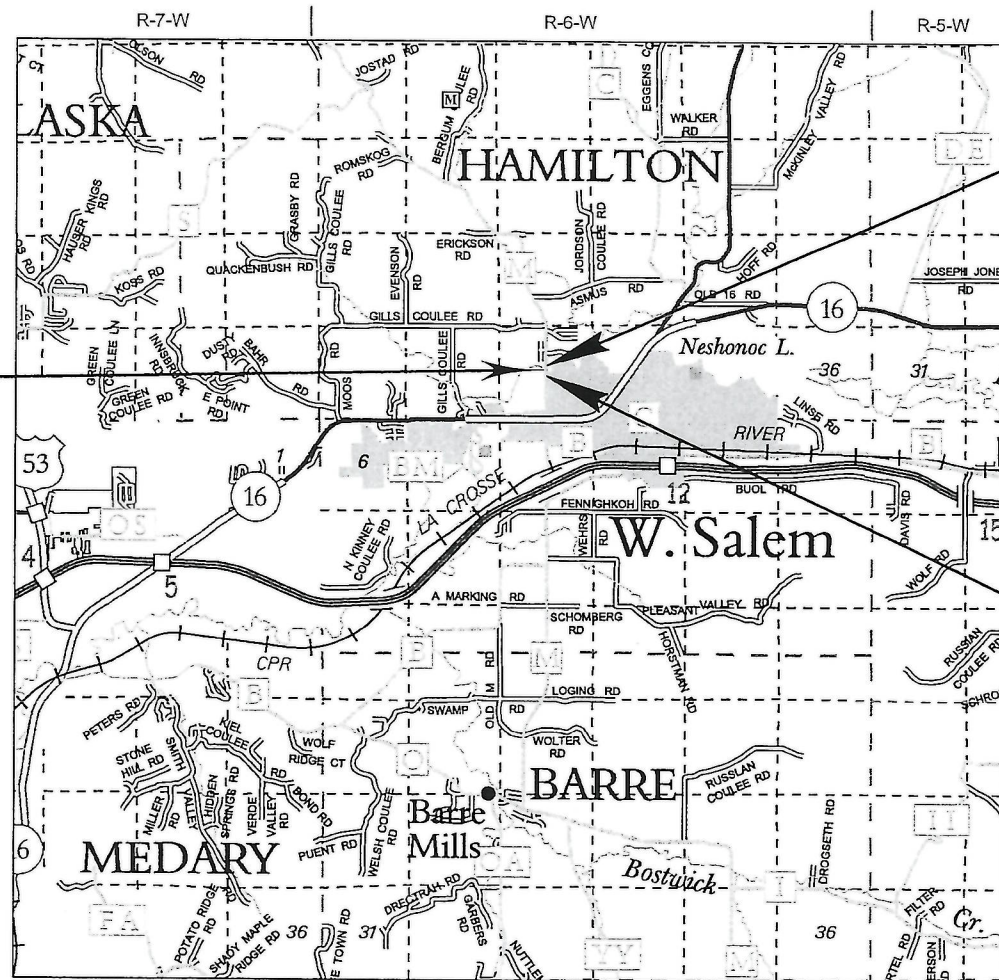

LAYOUT SCALE 0 2.0 MI

TOTAL NET LENGTH OF CENTERLINE = 0.130 MI

END PROJECT STA 31+16

BEGIN PROJECT STA 24+30
Y= 165,802.799
X= 484,730.622

STATE OF WISCONSIN
DEPARTMENT OF TRANSPORTATION

PLAN OF PROPOSED IMPROVEMENT

STH 16 - CTH S

LA CROSSE RIVER BRIDGE, B-32-0245

CTH M

LA CROSSE COUNTY

STATE PROJECT NUMBER

7323-00-71

STATE PROJECT	FEDERAL PROJECT	
	PROJECT	CONTRACT
7323-00-71		

ACCEPTED FOR

COUNTY OF LA CROSSE

6-27-23
(Date)

(Highway Commissioner Signature)

ORIGINAL PLANS PREPARED BY

Short Elliott Hendrickson Inc.
329 Jay Street, Suite 301
La Crosse, WI 54601-4007
608.782.3161 main |
888.908.8166 fax
Building a Better World for All of Us www.sehinc.com

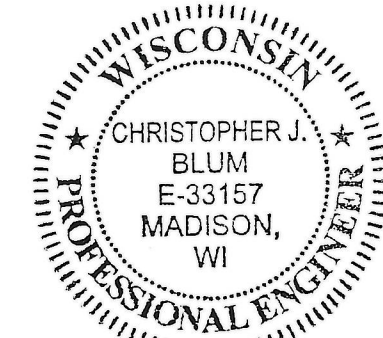

6-27-2023
(Date)

STATE OF WISCONSIN
DEPARTMENT OF TRANSPORTATION

PREPARED BY	
Surveyor	SEH
Designer	SEH
Project Manager	JENNIFER KOBYRN
Regional Examiner	SW REGION
Regional Supervisor	KYLE HEMP

APPROVED FOR THE DEPARTMENT

DATE: _____ (Signature)

E

PROPOSED STRUCTURE
B-32-0245
239.96' 3-SPAN 45W"
PRESTRESSED GIRDER BRIDGE

EXISTING STRUCTURE
B-32-0004

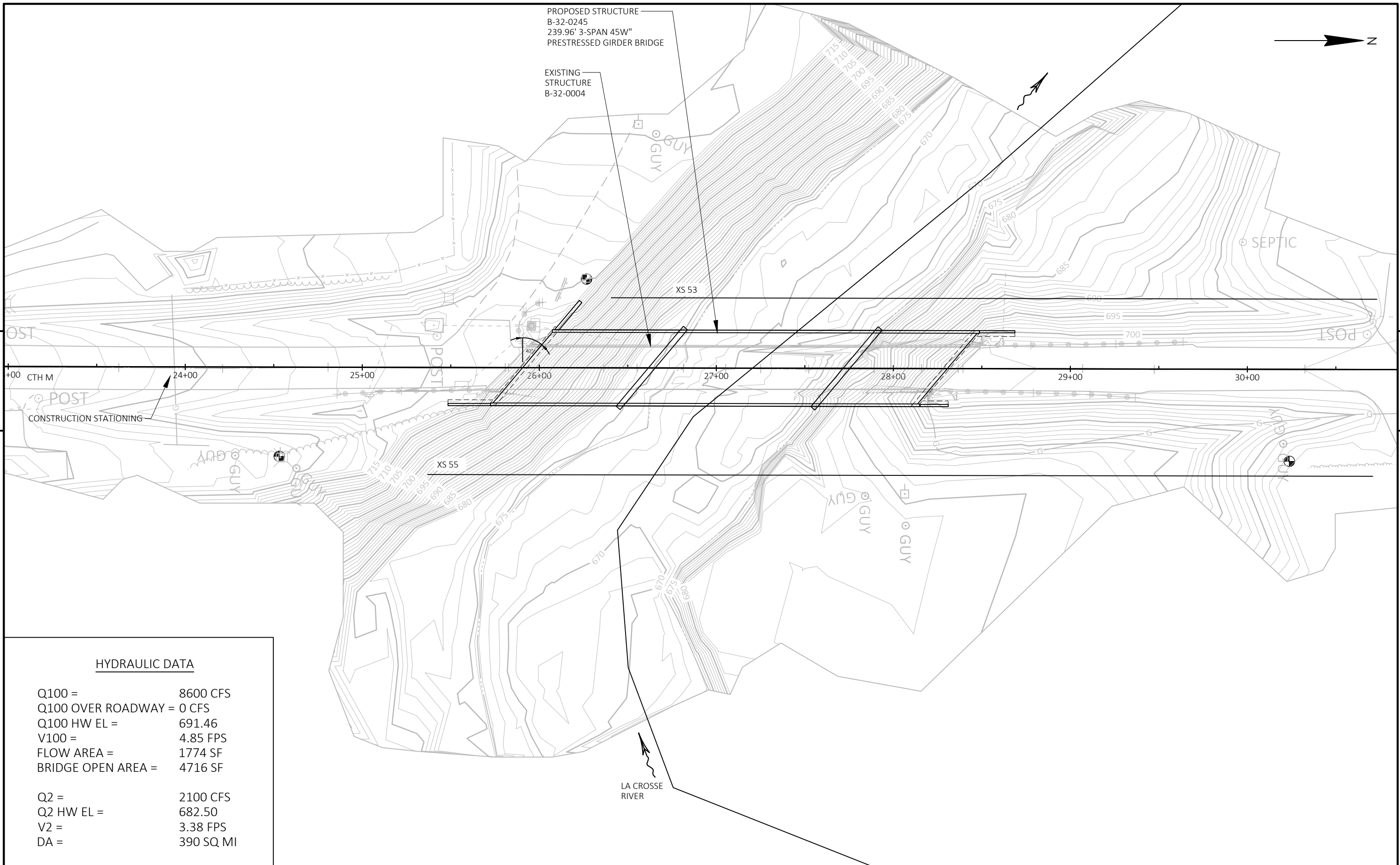
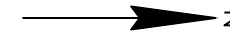

5

5

HYDRAULIC DATA

Q100 = 8600 CFS
 Q100 OVER ROADWAY = 0 CFS
 Q100 HW EL = 691.46
 V100 = 4.85 FPS
 FLOW AREA = 1774 SF
 BRIDGE OPEN AREA = 4716 SF

Q2 = 2100 CFS
 Q2 HW EL = 682.50
 V2 = 3.38 FPS
 DA = 390 SQ MI