

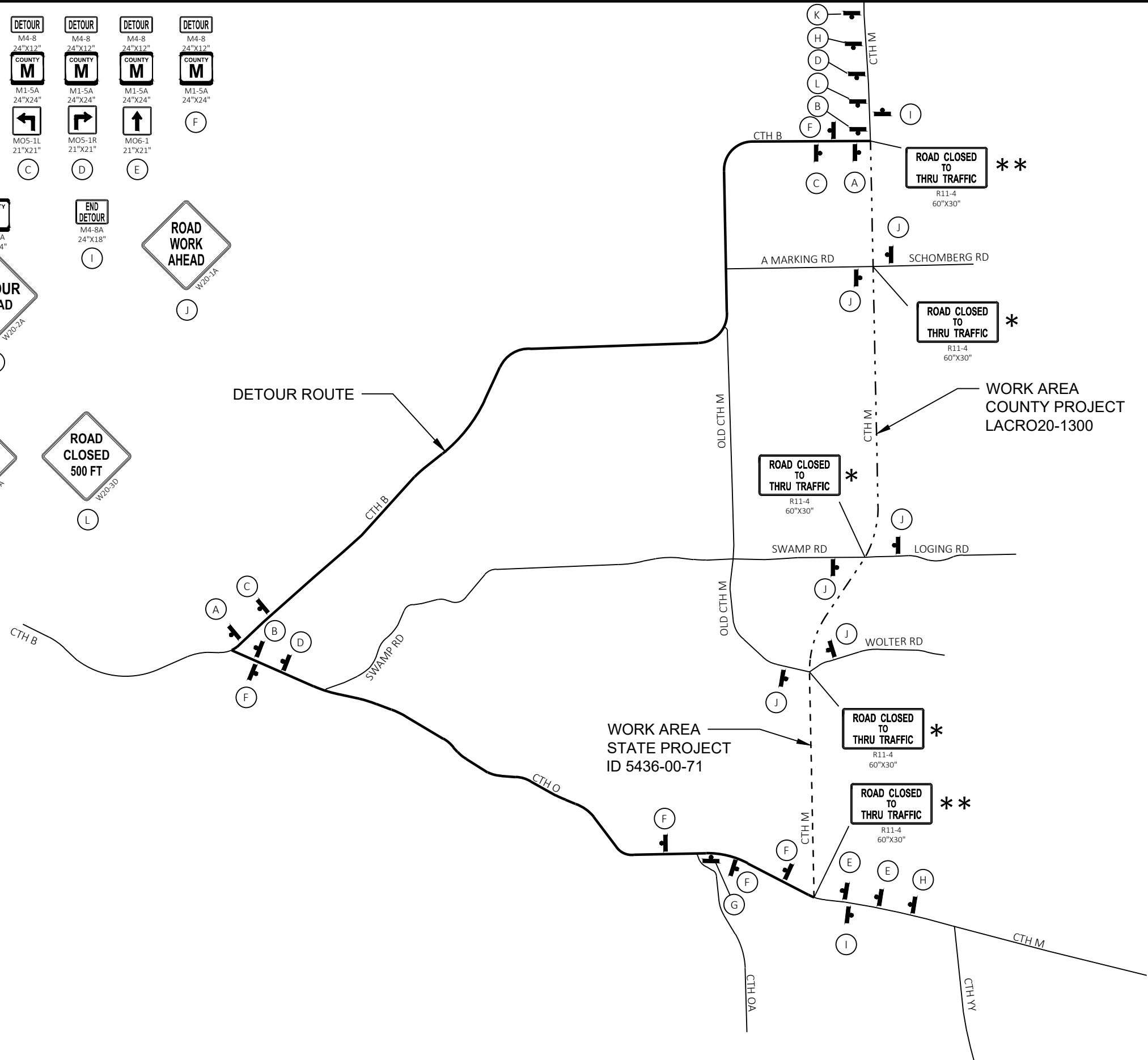

- DETOUR**
M4-8
24"x12"
COUNTY M
M1-5A
24"x24"
←
MO6-1
21"x21"
A
- DETOUR**
M4-8
24"x12"
COUNTY M
M1-5A
24"x24"
→
MO6-1
21"x21"
B
- DETOUR**
M4-8
24"x12"
COUNTY M
M1-5A
24"x24"
↶
MO5-1L
21"x21"
C
- DETOUR**
M4-8
24"x12"
COUNTY M
M1-5A
24"x24"
↷
MO5-1R
21"x21"
D
- DETOUR**
M4-8
24"x12"
COUNTY M
M1-5A
24"x24"
↑
MO6-1
21"x21"
E
- DETOUR**
M4-8
24"x12"
COUNTY M
M1-5A
24"x24"
○
F
- DETOUR**
M4-8
24"x12"
COUNTY M
M1-5A
24"x24"
○
G
- DETOUR**
M4-8
24"x12"
COUNTY M
M1-5A
24"x24"
○
H
- DETOUR**
M4-8
24"x12"
COUNTY M
M1-5A
24"x24"
○
I
- DETOUR**
M4-8
24"x12"
COUNTY M
M1-5A
24"x24"
○
J
- DETOUR**
M4-8
24"x12"
COUNTY M
M1-5A
24"x24"
○
K
- DETOUR**
M4-8
24"x12"
COUNTY M
M1-5A
24"x24"
○
L
- DETOUR**
M4-8
24"x12"
COUNTY M
M1-5A
24"x24"
○
M
- DETOUR**
M4-8
24"x12"
COUNTY M
M1-5A
24"x24"
○
N
- DETOUR**
M4-8
24"x12"
COUNTY M
M1-5A
24"x24"
○
O
- DETOUR**
M4-8
24"x12"
COUNTY M
M1-5A
24"x24"
○
P
- DETOUR**
M4-8
24"x12"
COUNTY M
M1-5A
24"x24"
○
Q
- DETOUR**
M4-8
24"x12"
COUNTY M
M1-5A
24"x24"
○
R
- DETOUR**
M4-8
24"x12"
COUNTY M
M1-5A
24"x24"
○
S
- DETOUR**
M4-8
24"x12"
COUNTY M
M1-5A
24"x24"
○
T
- DETOUR**
M4-8
24"x12"
COUNTY M
M1-5A
24"x24"
○
U
- DETOUR**
M4-8
24"x12"
COUNTY M
M1-5A
24"x24"
○
V
- DETOUR**
M4-8
24"x12"
COUNTY M
M1-5A
24"x24"
○
W
- DETOUR**
M4-8
24"x12"
COUNTY M
M1-5A
24"x24"
○
X
- DETOUR**
M4-8
24"x12"
COUNTY M
M1-5A
24"x24"
○
Y
- DETOUR**
M4-8
24"x12"
COUNTY M
M1-5A
24"x24"
○
Z

- ROAD CLOSED AHEAD**
W20-3A
K
- ROAD CLOSED 500 FT**
W20-3D
L



* SEE SDD "BARRICADES AND SIGNS FOR SIDEROAD CLOSURES" (DETAIL 3) FOR ADDITIONAL INFORMATION.

** SEE SDD "BARRICADES AND SIGNS FOR MAINLINE CLOSURES" FOR ADDITIONAL INFORMATION.

SEE SDD "DETOUR SIGNING FOR MAINLINE CLOSURES" FOR ADDITIONAL INFORMATION.

GENERAL NOTES: TRAFFIC CONTROL AND DETOURS

THE EXACT LOCATION AND SPACING OF ALL SIGNS AND DEVICES SHALL BE ADJUSTED TO FIT FIELD CONDITIONS AS APPROVED BY THE ENGINEER.

ALL SIGNS INAPPROPRIATE TO THE STATUS OF THE TRAFFIC CONTROL PLAN, INCLUDING PRE-EXISTING SIGNING IN THE VICINITY, SHALL BE COVERED OR REMOVED AS SPECIFIED IN THE PLANS AND/OR AS DIRECTED BY THE ENGINEER.

ALL "W" AND "WO" SIGNS SHALL BE 48"x48" UNLESS OTHERWISE NOTED AND SHALL HAVE REFLECTIVE FLORESCENT DIAMOND GRADE SHEETING.

"WO" SIGNS ARE THE SAME AS "W" SIGNS EXCEPT THAT THE BACKGROUND IS ORANGE.

SEE SDD "TRAFFIC CONTROL, ADVANCED WARNING SIGNS 45 MPH OR GREATER UNDIVIDED ROAD OPEN TO TRAFFIC" FOR ADDITIONAL INFORMATION.

PROJECT NO: 5436-00-71	HWY: CTH M	COUNTY: LA CROSSE	TRAFFIC CONTROL PLAN	SHEET	E
------------------------	------------	-------------------	----------------------	-------	----------