

BENCH MARKS			
NO.	STA.	DESCRIPTION	ELEV.
50	29+72.8	RR SPK IN E END OF S ABUT., 16.6' RT.	735.84
51	31+48.3	RR SPIKE IN POWER POLE, 26.7' LT.	733.85

**TEMPORARY BYPASS
ADVISORY SPEED
15 MPH**

NOTE:
FOR ALIGNMENT CONTROL POINTS, TIES,
BEARINGS, AND COORDINATES, SEE
"ALIGNMENT CONTROLS" SHEET.

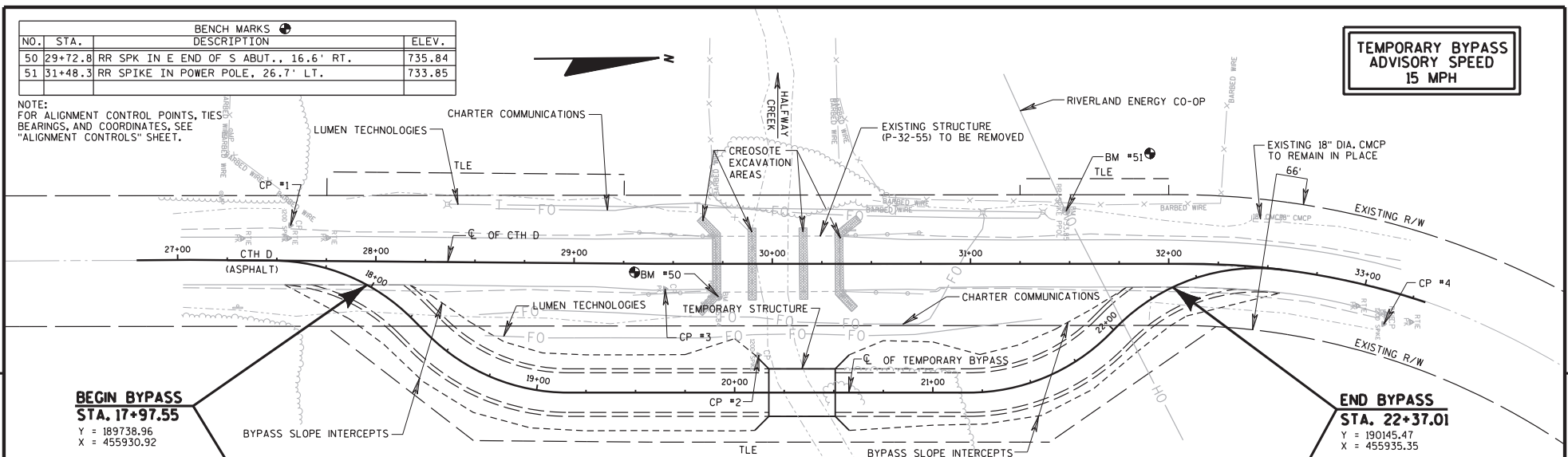

**BEGIN BYPASS
STA. 17+97.55**
Y = 189738.96
X = 455930.92

**END BYPASS
STA. 22+37.01**
Y = 190145.47
X = 455935.35

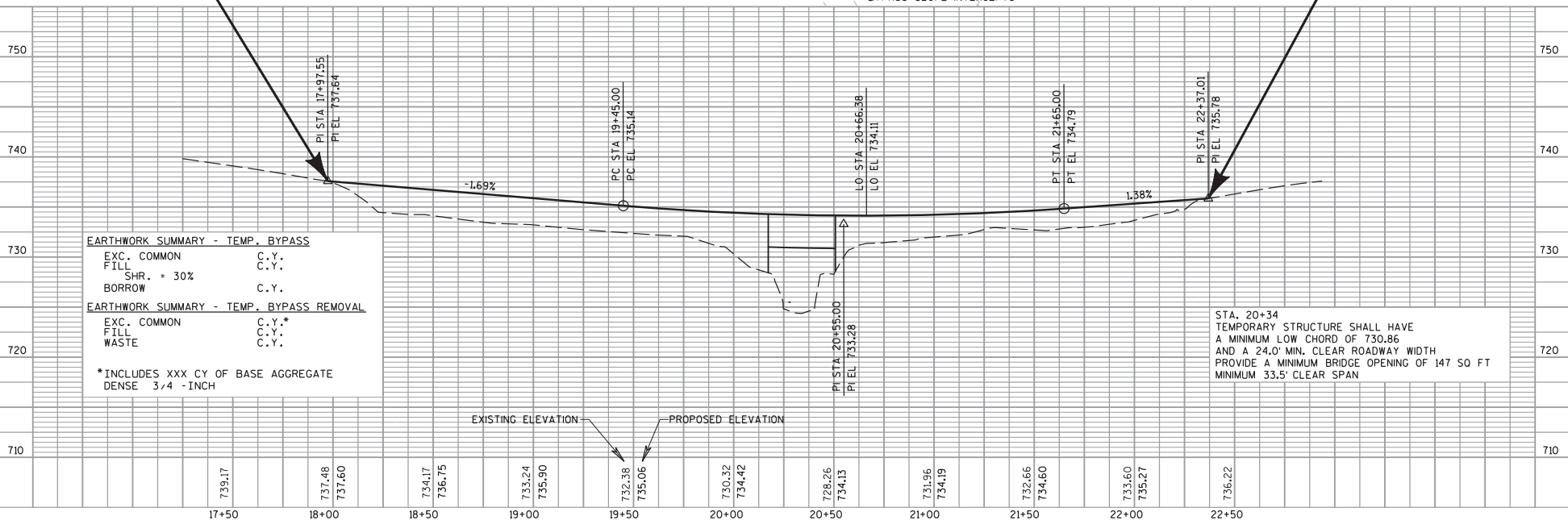

EARTHWORK SUMMARY - TEMP. BYPASS	
EXC. COMMON	C.Y.
FILL	C.Y.
SHR. = 30%	
BORROW	C.Y.
EARTHWORK SUMMARY - TEMP. BYPASS REMOVAL	
EXC. COMMON	C.Y.*
FILL	C.Y.
WASTE	C.Y.

*INCLUDES XXX CY OF BASE AGGREGATE DENSE 3/4 - INCH

PROJECT NO: 7049-00-70 HWY: CTH D COUNTY: LA CROSSE PLAN AND PROFILE - BYPASS SCALE, FEET 0 25 50 SHEET E