

STATE PROJECT	FEDERAL PROJECT	
	PROJECT	CONTRACT
5436-00-75		

**STATE OF WISCONSIN  
DEPARTMENT OF TRANSPORTATION**

**PLAN OF PROPOSED IMPROVEMENT  
CTH YY - CTH I  
RUSSIAN COULEE CREEK BRIDGE B32XXXX  
CTH M  
LA CROSSE COUNTY**

STATE PROJECT NUMBER  
**5436-00-75**

STRUCTURE B-32-XXXX

**ORDER OF SHEETS**

Section No. 1	Title
Section No. 2	Typical Sections and Details (Includes Erosion Control Plans)
Section No. 3	Estimate of Quantities
Section No. 3	Miscellaneous Quantities
Section No. 4	Right of Way Plat
Section No. 5	Plan and Profile
Section No. 6	Standard Detail Drawings
Section No. 7	Sign Plates
Section No. 8	Structure Plans
Section No. 9	Computer Earthwork Data
Section No. 9	Cross Sections

TOTAL SHEETS =

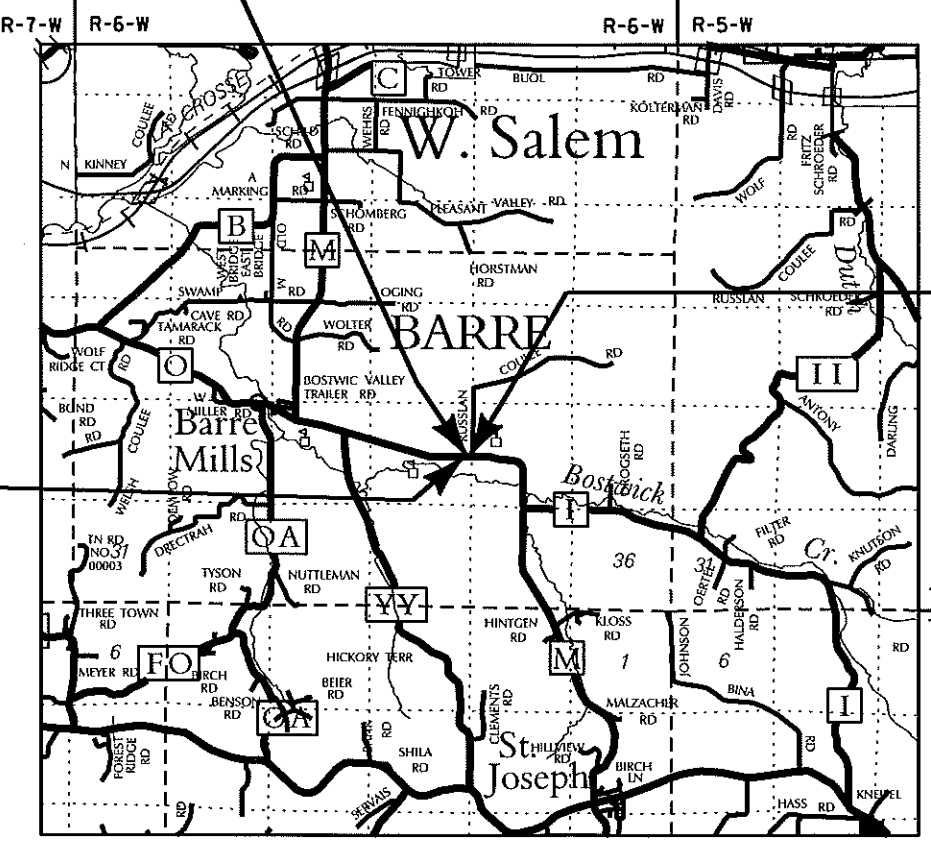
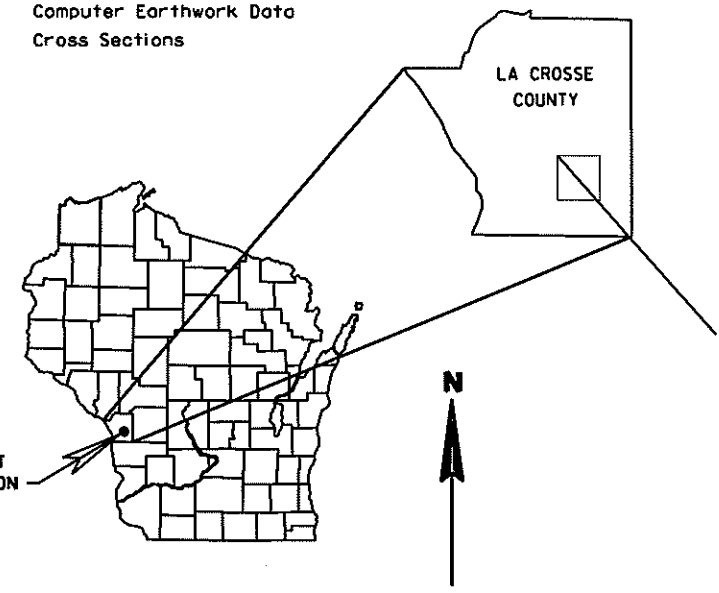

**DESIGN DESIGNATION**

A.A.D.T. (2021)	=	2,400
A.A.D.T. (2041)	=	3,200
D.H.V.	=	240
D.	=	50/50
T.	=	5%
DESIGN SPEED	=	XX MPH
ESALS	=	xx,xxxx

**CONVENTIONAL SYMBOLS  
PLAN**

CORPORATE LIMITS	
PROPERTY LINE	
LOT LINE	
LIMITED HIGHWAY EASEMENT	
EXISTING RIGHT OF WAY	
PROPOSED OR NEW R/W LINE	
SLOPE INTERCEPT	
REFERENCE LINE	
EXISTING CULVERT	
PROPOSED CULVERT (Box or Pipe)	
COMBUSTIBLE FLUIDS	
HIGH VOLTAGE	
MARSH AREA	
WOODED OR SHRUB AREA	

<b>PROFILE</b>	
GRADE LINE	
ORIGINAL GROUND	
MARSH OR ROCK PROFILE (To be noted as such)	
SPECIAL DITCH	
GRADE ELEVATION	
CULVERT (Profile View)	
<b>UTILITIES</b>	
OVERHEAD	
ELECTRIC	
FIBER OPTIC	
GAS	
SANITARY SEWER	
STORM SEWER	
TELEPHONE	
WATER	
UTILITY PEDESTAL	
POWER POLE	
TELEPHONE POLE	

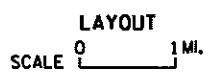

TOTAL NET LENGTH OF CENTERLINE = XX MI.

END PROJECT  
STA.  
Y \*  
X \*

BEGIN PROJECT  
STA.  
Y \*  
X \*

**ACCEPTED FOR**

County of La Crosse

Date \_\_\_\_\_ Highway Commissioner \_\_\_\_\_

ORIGINAL PLANS PREPARED BY  
**AYRES ASSOCIATES** 3433 Oakwood Hills Parkway  
Eau Claire, WI 54601  
www.AyresAssociates.com

DATE \_\_\_\_\_

**STATE OF WISCONSIN  
DEPARTMENT OF TRANSPORTATION**

PREPARED BY  
Surveyor AYRES ASSOCIATES INC  
Designer AYRES ASSOCIATES INC

Regional Examiner SOUTHWEST REGION  
Regional Supervisor \_\_\_\_\_

APPROVED FOR THE DEPARTMENT

DATE: \_\_\_\_\_ (Signature)

**E**

SURVEY PERFORMED IN 2019.  
COORDINATES ON THIS PLAN ARE REFERENCED TO  
THE WISCONSIN COUNTY COORDINATE SYSTEM (WCCS),  
LA CROSSE COUNTY.

PROJECT ID: 5436-00-75  
WITH: N/A

COUNTY: LA CROSSE

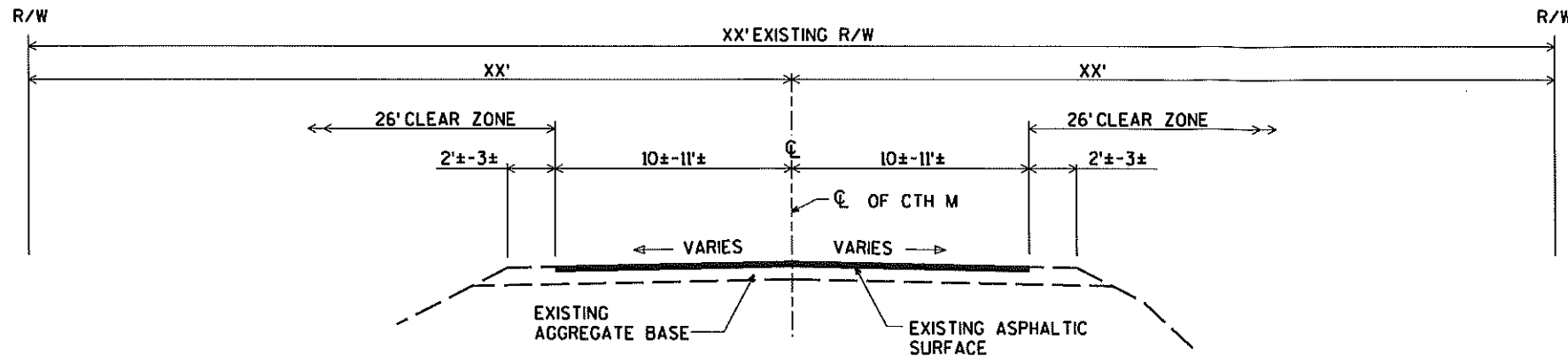

**EXISTING TYPICAL SECTION**

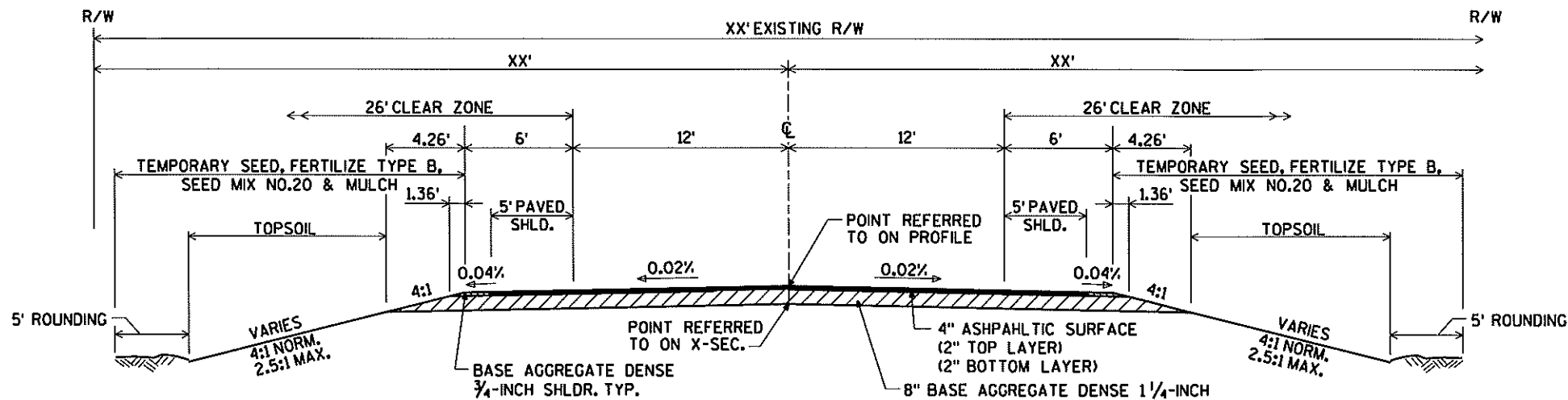

**FINISHED TYPICAL SECTION**

**GENERAL NOTES**

EROSION CONTROL ITEMS TO BE PLACED AS SHOWN ON THE PLAN OR AS DIRECTED BY THE ENGINEER.

NO TREES AND/OR SHRUBS ARE TO BE REMOVED WITHOUT THE APPROVAL OF THE ENGINEER.

THE LOCATIONS OF EXISTING AND PROPOSED UTILITY INSTALLATIONS AS SHOWN ON THE PLANS ARE APPROXIMATE. THERE MAY BE OTHER UTILITY INSTALLATIONS WITHIN THE PROJECT AREA THAT ARE NOT SHOWN.

DISTURBED AREAS WITHIN THE RIGHT-OF-WAY, EXCLUSIVE OF THE ROADBED, SHALL BE FERTILIZED, SEEDED, AND MULCHED AS DIRECTED BY THE ENGINEER.

WHEN THE QUANTITY OF THE ITEM OF BASE AGGREGATE DENSE IS MEASURED FOR PAYMENT BY THE TON, THE DEPTH OR THICKNESS OF THE LAYER SHOWN ON THE PLANS IS APPROXIMATE AND THE ACTUAL THICKNESS WILL DEPEND ON THE DISTRIBUTION OF THE MATERIAL AS DIRECTED BY THE ENGINEER.

ASPHALTIC REMOVAL IS INCLUDED IN THE ITEM EXCAVATION COMMON.

TOPSOIL SHALL BE PLACED ON THE SLOPES, TO THE POINT OF INTERCEPT WITH THE ORIGINAL GROUND SHOWN ON THE CROSS SECTIONS.

THE DEPARTMENT OF TRANSPORTATION WILL FURNISH THE CONTRACTOR WITH A MONUMENT TO BE INSTALLED BY THE CONTRACTOR AS DIRECTED BY THE ENGINEER.

ELEVATIONS SHOWN ON THIS PLAN ARE REFERENCED TO THE NORTH AMERICAN VERTICAL DATUM (NAVD 88).

ASPHALT SURFACE SHALL USE 1/2" NOMINAL AGGREGATE SIZE.

WETLANDS EXIST IN THE PROJECT AREA. NO DISTURBANCE IS ALLOWED OUTSIDE THE SLOPE INTERCEPTS.

**UTILITIES**

CHARTER COMMUNICATIONS  
COMMUNICATIONS  
1228 12TH AVENUE S  
ONALASKA, WI 54650  
ATTN: PERRY MCCLELLAN  
608-370-7140  
perry.mcclellan@charter.com

XCEL ENERGY  
GAS AND ELECTRIC DISTRIBUTION  
5050 SERVICE DRIVE  
WINONA, 32 55987  
ATTN: SCOTT ROBERTS  
608-789-3625  
scott.w.roberts@xcelenergy.com

CENTURY LINK  
TELEPHONE  
333 NORTH FRONT ST  
LA CROSSE, WI 54601  
ATTN: BRIAN STELPLUGH  
608-796-5124  
brian.stelplugh@centurylink.com

MIDWEST NATURAL GAS INCORPORATED  
GAS  
3600 STH 157  
P.O. BOX 429  
LA CROSSE, WI 54602  
ATTN: DOUG DICKINSON  
608-781-1011  
doug@midwestnaturalgas.com



Dial 811 or (800) 242-8511  
www.DiggersHotline.com

**WISCONSIN DEPARTMENT OF NATURAL RESOURCES CONTACT:**

KAREN KALVELAGE  
3550 MORMON COULEE RD.  
LA CROSSE, WI 54601  
608-785-9115  
608-406-7880  
karen.kalvelage@wisconsin.gov

**DESIGNER**

AYRES ASSOCIATES  
3433 OAKWOOD HILLS PARKWAY  
EAU CLAIRE, WI 54701  
ATTN: DANIEL N. SYDOW  
715-834-3161  
sydowd@ayresassociates.com

**COUNTY CONTACT:**

LA CROSSE COUNTY, HIGHWAY DEPARTMENT  
301 CARLSON RD.  
WEST SALEM, WI 54669  
ATTN: RON CHAMBERLAIN  
605-786-3810  
rchamberlain@lacrosecounty.org

# ALTERNATIVE A

525' PROJECT LENGTH  
45 MPH DESIGN SPEED

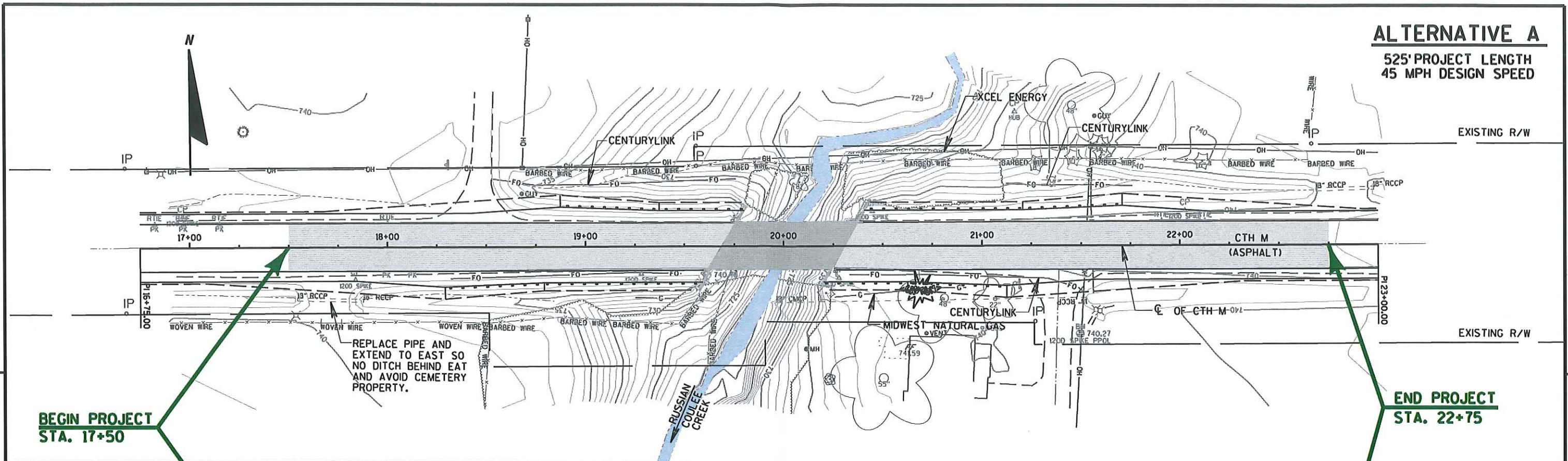

BEGIN PROJECT  
STA. 17+50

END PROJECT  
STA. 22+75

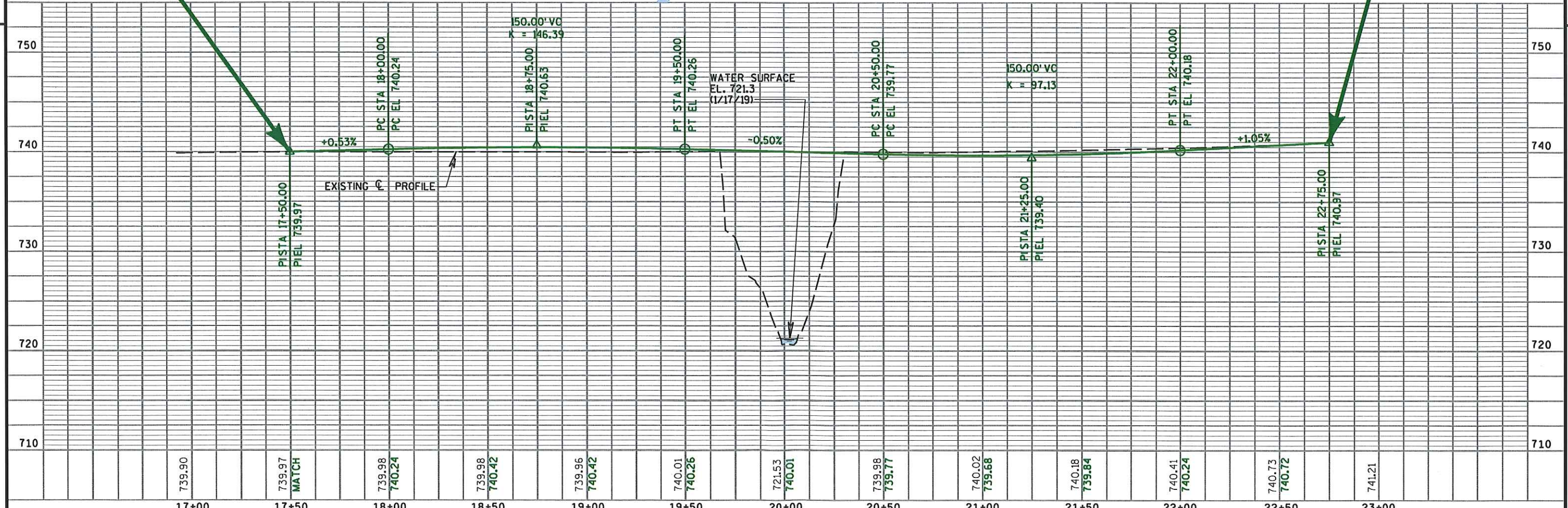

739.90	739.97	739.98	739.98	739.96	740.01	721.53	739.98	740.02	740.18	740.41	740.73	741.21
	MATCH	740.24	740.42	740.42	740.26	740.01	739.77	739.68	739.84	740.24	740.72	
17+00	17+50	18+00	18+50	19+00	19+50	20+00	20+50	21+00	21+50	22+00	22+50	23+00

PROJECT NO: 5436-00-75 | HWY: CTH M | COUNTY: La CROSSE | PLAN AND PROFILE - ALTERNATIVE A (45 MPH) | SCALE, FEET 0 25 50 | SHEET E

# ALTERNATIVE B

550' PROJECT LENGTH  
55 MPH DESIGN SPEED

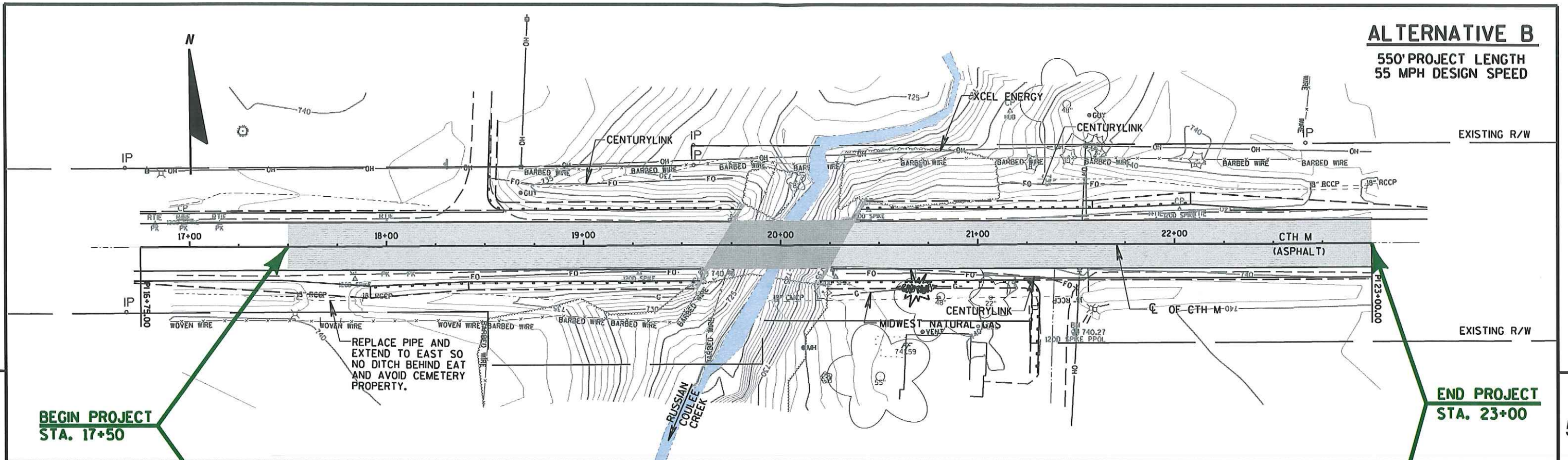

**BEGIN PROJECT STA. 17+50**

**END PROJECT STA. 23+00**

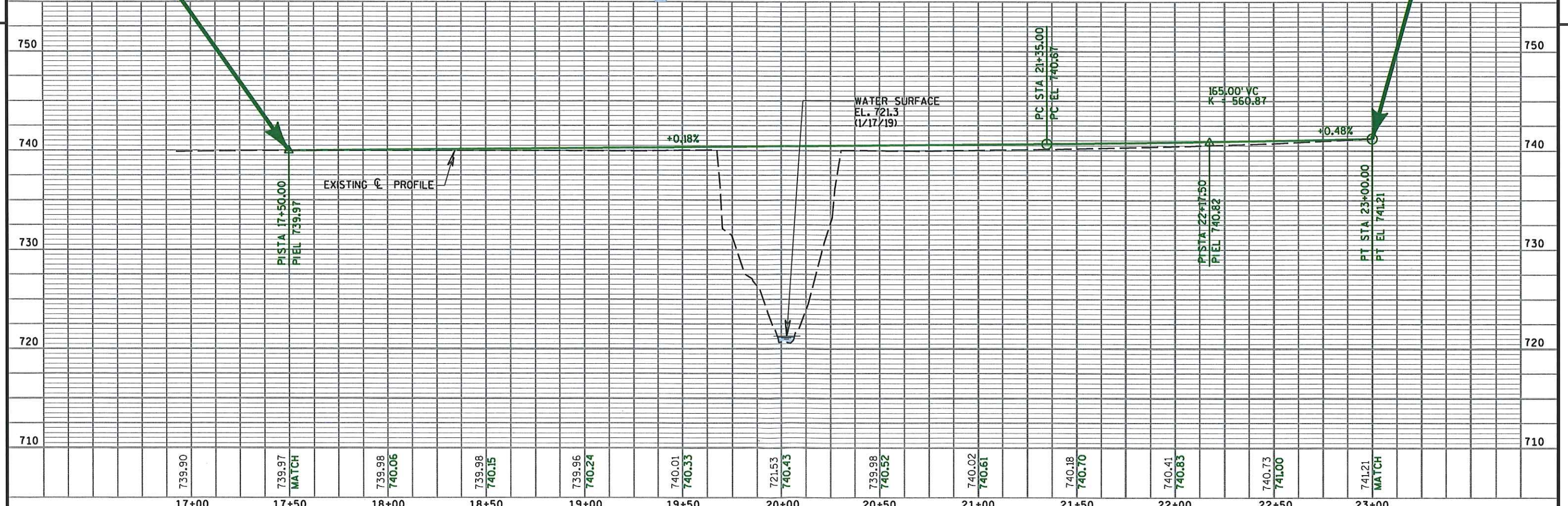

739.90	739.97	739.98	739.98	739.96	740.01	721.53	739.98	740.02	740.18	740.41	740.73	741.21
	MATCH	740.06	740.15	740.24	740.33	740.43	740.52	740.61	740.70	740.83	741.00	MATCH
17+00	17+50	18+00	18+50	19+00	19+50	20+00	20+50	21+00	21+50	22+00	22+50	23+00

PROJECT NO: 5436-00-75 | HWY: CTH M | COUNTY: La CROSSE | PLAN AND PROFILE - ALTERNATIVE B (55 MPH) | SCALE, FEET 0 25 50 | SHEET E

# STRUCTURE

SINGLE-SPAN 36W" PRESTRESSED CONCRETE GIRDER BRIDGE ON 7' TALL SILL-TYPE (A) ABUTMENTS WITH ELEPHANT EAR WINGS  
30° LHF SKEW

