

CONDITIONAL USE PERMIT NO. 848

REPORT OF THE PLANNING, RESOURCES AND DEVELOPMENT COMMITTEE
TO THE COUNTY BOARD ON A HEARING FOR A CONDITIONAL USE PERMIT

TO THE COUNTY BOARD OF SUPERVISORS OF LA CROSSE COUNTY:

The La Crosse County Planning, Resources and Development Committee, having considered an application filed by:

JOHN DIETRICH AND KIRBY PABST FOR PABST ENGINEERING & MANUFACTURING INC, 1215 WELL ST, ONALASKA, WI 54650; ACTING ON BEHALF OF FRANK A & JANICE M FOGEL AND FRANKS REPAIR, W7891 COUNTY ROAD Z, ONALASKA, WI 54650

and having held a public hearing on the 30th day of January, 2012 for a Conditional Use Permit to operate a test site for a full featured modular anaerobic digester machine which will consist of 1-6 tanks in the 2,000-32,000 gallon range. Refuse, food waste, manure and paunch manure will be added to this pilot thermophillic anaerobic digester. Residual solids and liquids from the digester will be land spread to the John Schaller farm on Brices Prairie to incorporate into any nutrient management plan he may have. This project is proposed on a 0.69 acre parcel south of N6281 County Road ZB on land zoned AGRICULTURE DISTRICT "A" in the Town of ONALASKA and described as follows:

Lot 3 of Certified Survey Map No. 35 in Volume 9, Town of Onalaska.

And pursuant to s. 59.69 Wis. Stats. and s. 17.36 Zoning Code: the Committee did publish and receive proof of a Class II notice of the hearing; did receive receipts of mailing of the notices to the affected Town Clerk(s); did hold a public hearing to hear testimony or correspondence from the people; and, did receive and consider action from the affected Town Board(s). The Committee, under s. 91.48(1), Wis. Stats., along with the affected Town Board(s), under s. 17.36(4), have the authority to approve the application with integral conditions or to disapprove of the application. Having considered the entire record the Committee's recommendation is to:

By a vote of 5 in favor, 2 excused – Keil & Pedretti, the Committee recommended approval of this permit subject to nineteen (19) conditions listed on page 2 of this document:

1. This Conditional Use Permit (CUP) is issued to John Dietrich and Kirby Pabst to locate and operate one pilot thermophillic anaerobic digester on a 0.69 acre parcel described as Lot 3 of CSM No. 35, Volume 9, in the Town of Onalaska owned by Frank and Janice Fogel.
2. This approval is for four (4) 1,000 gallon influent and effluent storage and processing tanks and one (1) 2,000 gallon digester only.
3. Incoming waste stream is limited to liquid food waste from the Monroe County Landfill, paunch manure from VPP Group of Norwalk, WI and manure from the John Schaller farm in accordance with WI DNR WPDES General Permit No. WI-0055867-05. No other solid or demolition waste material or liquid waste shall be used.
4. Waste introduced, stored and processed at this site shall be limited to no more than 400 gallons per day and no more than 2,000 gallons per week.
5. A letter of approval from the Holmen Fire Department obtained by the applicant shall be provided to the Zoning Department and made part of this file if a flare is used to burn excess gas.
6. No vehicles transporting waste to the site or waste material from the site are allowed outside the hours of 7 a.m. to 8 p.m., Monday through Saturday.
7. All waste material to be landspread shall be applied only in accordance with an approved nutrient management plan.
8. No outside storage of influent or effluent waste material is allowed at the site. Clean up of any waste material shall be in accordance with an Emergency Action Plan that is part of an approved Animal Waste Impoundment Permit issued by the La Crosse County Conservation Department.
9. A Zoning/Occupancy Permit and 911# shall be required for this facility.
10. Correspondence from the La Crosse County Environmental Health Department outlining sanitation requirements for employees at this facility shall be provided to the Zoning Department by the applicant.
11. This facility shall be removed from this location and moved to an approved site within 90 days of discontinuance of operation.
12. A bond in the amount of \$5,000 shall be provided by the applicant to La Crosse County in the event compliance with the preceding condition must be accomplished by the county.
13. This permit expires 5 years from the date of approval by the La Crosse County Board of Supervisors.
14. Any proposed change to tank capacity, numbers of tanks, or extension of the expiration date of this permit requires re-application and amendment to this CUP.
15. Any findings of non-compliance with WI DNR Clean Air Standards shall result in rehearing and possible termination of CUP #848.
16. Adequate liability and property damage insurance is the responsibility of the applicant.
17. Regular reports to the La Crosse County Solid Waste Department are required.
18. A security fence around the facility or approved security plan is required.
19. This permit is non-transferable.

Dated this 9th day of February 2012

ZONING, PLANNING AND LAND INFORMATION DEPARTMENT

BY

Nathan Sampson, Interim Director

LA CROSSE COUNTY PLANNING, RESOURCES AND DEVELOPMENT COMMITTEE

BY

Donald F Meyer - Chair

THE COUNTY BOARD took the following action this 16th of February 2012

Approved subject to conditions as outlined

Disapproved the application

STATE OF WISCONSIN
COUNTY OF LA CROSSE

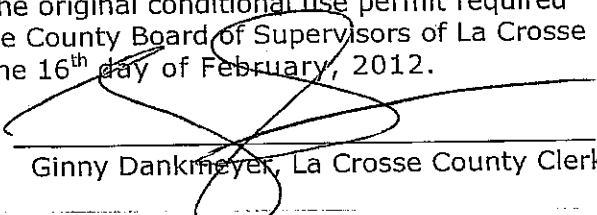

I, Ginny Dankmeyer, County Clerk of La Crosse County do hereby certify that this document is a true and correct copy of the original conditional use permit required by law to be in my custody and which the County Board of Supervisors of La Crosse County approved at a meeting held on the 16th day of February, 2012.

Ginny Dankmeyer, La Crosse County Clerk

SITE LOCATION

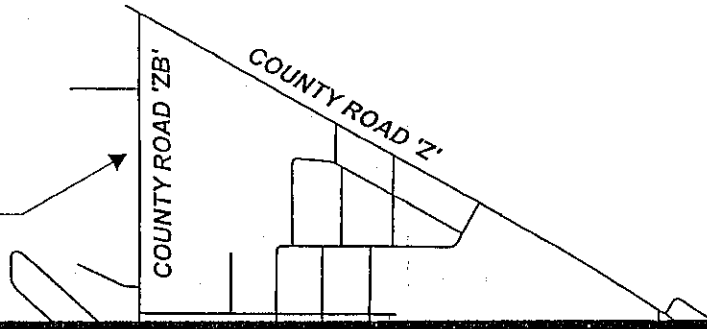
SCALE: 1" = 2,000'



-  AGRICULTURE DISTRICT 'A'
-  TRANSITIONAL AGRICULTURE

SCALE: 1" = 150'

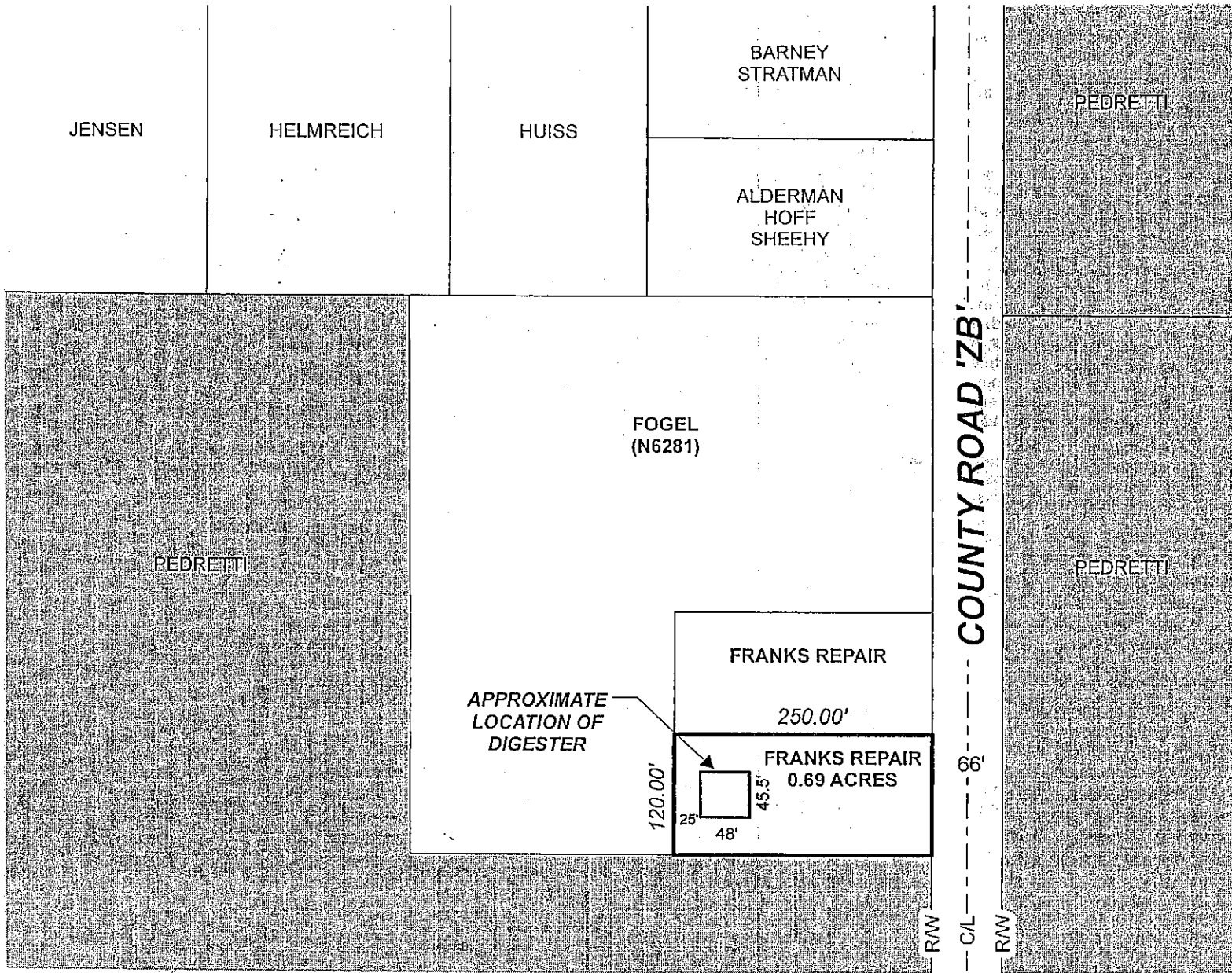

CONDITIONAL USE PERMIT NO. 848

LOT 3 OF CERTIFIED SURVEY MAP VOLUME 9, PAGE 35

TOWN OF ONALASKA

KIRRY PARST PARST ENGINEERING & MANUFACTURING INC. O.B.O. FRANKS REPAIR