

CONDITIONAL USE PERMIT NO. 859

REPORT OF THE PLANNING, RESOURCES AND DEVELOPMENT COMMITTEE
TO THE COUNTY BOARD ON A HEARING FOR A CONDITIONAL USE PERMIT

TO THE COUNTY BOARD OF SUPERVISORS OF LA CROSSE COUNTY:

The La Crosse County Planning, Resources and Development Committee, having considered an application filed by:

SHELDON EVERSON, D/B/A A+ ROLL-OFF, LLC, W2863 COUNTY ROAD T, MINDORO, WI 54644

and having held a public hearing on the 30th day of July, 2012 for a Conditional Use Permit to continue operating a dumpster roll-off business as approved under CUP 815 that expires August 19, 2012; and to amend conditions of that permitting including number of dumpsters allowed to be stored on-site, number of employees, and to establish business hours, on land zoned AGRICULTURE DISTRICT "A" in the Town of Farmington and described as follows:

Part of the NW-SW of Section 24, T18N, R6W lying southwesterly of County Road T and further described as Tax Parcel 5-1080-1. Town of Farmington. Property address is W2863 County Road T.

And pursuant to s. 59.69 Wis. Stats. and s. 17.36 Zoning Code: the Committee did publish and receive proof of a Class II notice of the hearing; did receive receipts of mailing of the notices to the affected Town Clerk(s); did hold a public hearing to hear testimony or correspondence from the people; and, did receive and consider action from the affected Town Board(s). The Committee, under s. 91.48(1), Wis. Stats., along with the affected Town Board(s), under s. 17.36(4), have the authority to approve the application with integral conditions or to disapprove of the application. Having considered the entire record the Committee's recommendation is to:

By vote of five (5) in favor, two (2) excused (Holtze, Ebert), the committee recommended approval of Conditional Use Permit No. 859 subject to the following seven (7) conditions:

1. Operate with two (2) hauling trucks;
2. Fifteen (15) empty (at all times) dumpsters may be stored on site;
3. One (1) unlighted sign with zoning permit;
4. Up to two (2) employees besides owner(s);
5. This permit expires at the end of four (4) years after county board approval;
6. Hours of operation are from 6:00 a.m. to 7:00 p.m. daily; and
7. This permit is non-transferable.

Dated this 8th day of August 2012

ZONING, PLANNING AND LAND INFORMATION DEPARTMENT

BY 
Nathan Sampson, Director

LA CROSSE COUNTY PLANNING, RESOURCES AND DEVELOPMENT COMMITTEE

BY 
Marilyn Pedretti - Chair

THE COUNTY BOARD took the following action this 16th of August, 2012

Approved subject to conditions as outlined

Disapproved the application

STATE OF WISCONSIN
COUNTY OF LA CROSSE

I, Ginny Dankmeyer, County Clerk of La Crosse County do hereby certify that this document is a true and correct copy of the original conditional use permit required by law to be in my custody and which the County Board of Supervisors of La Crosse County approved at a meeting held on the 16th day of August, 2012

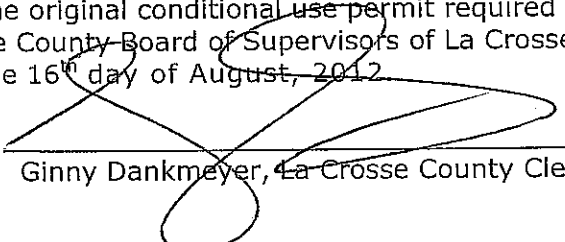
Ginny Dankmeyer, La Crosse County Clerk

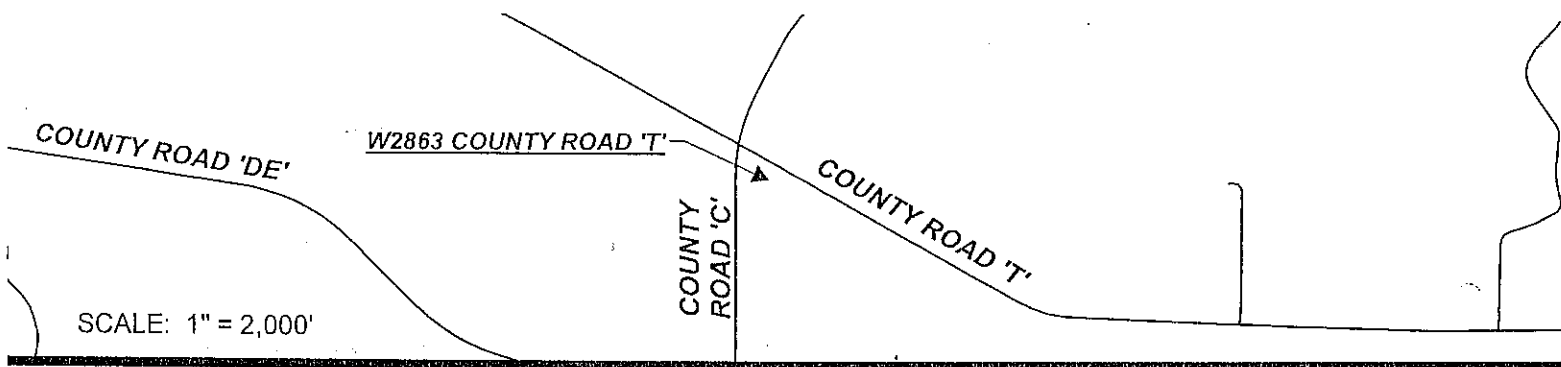

- AGRICULTURAL DISTRICT 'A'
- EXCLUSIVE AGRICULTURAL DISTRICT

SCALE: 1" = 150'

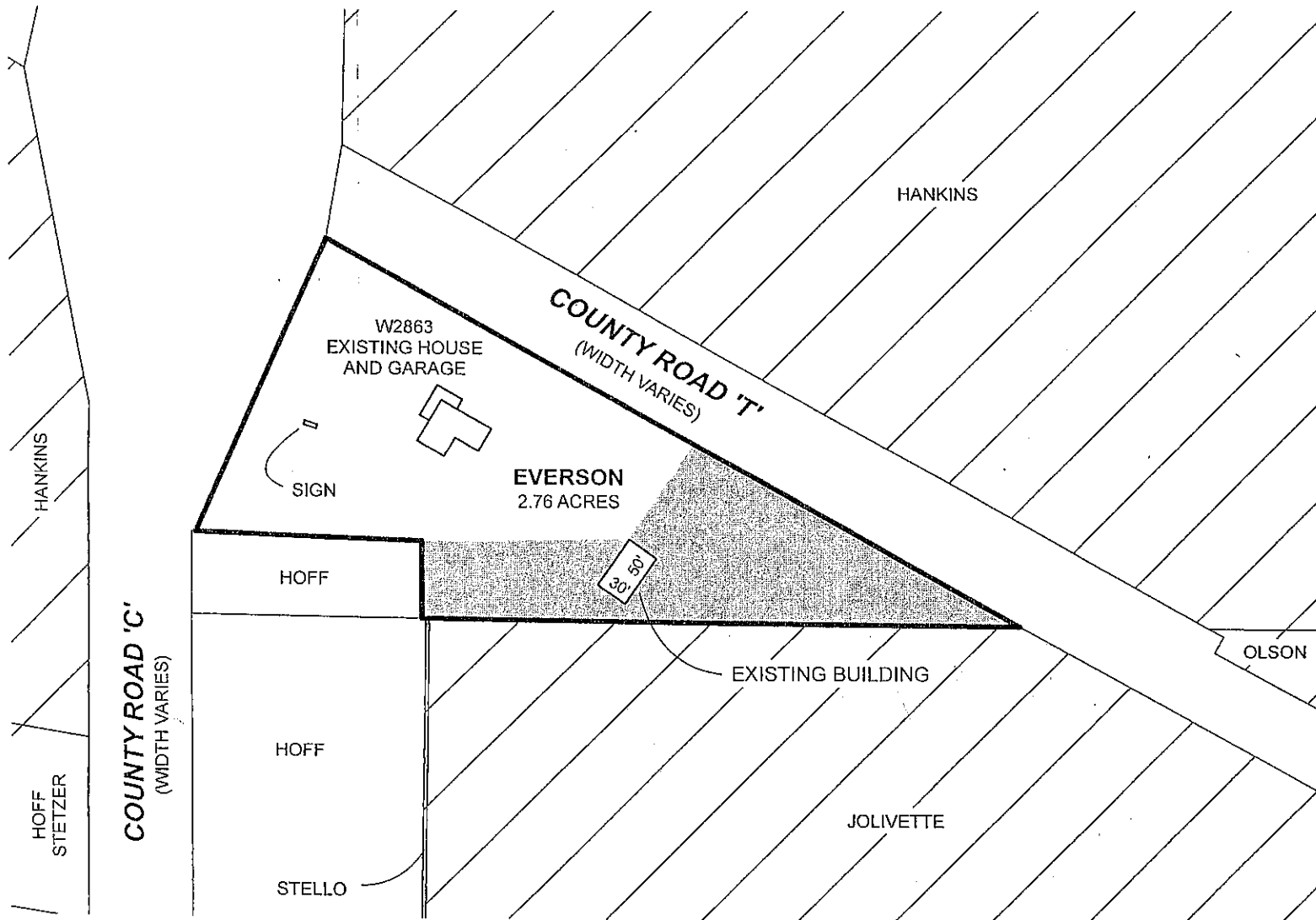

**PROPOSED CONDITIONAL USE PERMIT NO. 859
EXISTING BUILDING AND SHADED PORTION
SHOWN HEREON TO BE USED FOR A+ ROLL-OFF, LLC**

**CONDITIONAL USE PERMIT NO. 815 WAS APPROVED
ON AUGUST 19, 2010 FOR A DUMPSTER ROLL-OFF
BUSINESS AND WILL EXPIRE ON AUGUST 19, 2012**

CONDITIONAL USE PERMIT NO. 859
 PART OF THE NW/SW OF SECTION 24, T18N, R6W
 TOWN OF FARMINGTON
 SHELDON E EVERSON