

REPORT OF THE PLANNING, RESOURCES AND DEVELOPMENT COMMITTEE
TO THE COUNTY BOARD ON A HEARING FOR A CONDITIONAL USE PERMIT

TO THE COUNTY BOARD OF SUPERVISORS OF LA CROSSE COUNTY:

The La Crosse County Planning, Resources and Development Committee, having considered to application filed by:

F. DAVID & DIANE WOLF, W2105 COUNTY ROAD B, WEST SALEM, WI 54669

and having held a public hearing on the 29th day of August, 2011 for a Conditional Use Permit to expand a non-metallic mining operation to extract sand as borrow material originally approved by the La Crosse County Board of Supervisors on September 22, 2005, to include a new 7.37 acre parcel of land zoned EXCLUSIVE AGRICULTURE DISTRICT in the Town(s) of BANGOR and BURNS on land described as follows:

Part of the Fractional NW-NE, Section 6, T16N, R5W, and part of Government Lot 7, Section 31, T17N, R5W, La Crosse County, Wisconsin described as follows: Commencing at the northeast corner of Section 6, S70°31'13"W 1825.75' to the southwest corner of Conditional Use Permit #693 and the POB, N42°25'31"W 116.89', N65°06'57"W 599.90', N78°19'36"W 305.96' to the west line of said Fractional NW-NE, along said West line N00°32'47"E 190.41' to the northwest corner of said Fractional NW-NE and the southwest corner of Government Lot 7, along the West line of said Government 7 northerly 77.46', N75°57'30"E 240.37', southeasterly 761.37', more or less, to the northwest corner of said Conditional Use Permit #693, south 400.00' to the POB. TW an expanded haul road. Town of Bangor/Town of Burns.

And pursuant to s. 59.69 Wis. Stats. and s. 17.36 Zoning Code: the Committee did publish and receive proof of a Class II notice of the hearing; did receive receipts of mailing of the notices to the affected Town Clerk(s); did hold a public hearing to hear testimony or correspondence from the people; and, did receive and consider action from the affected Town Board(s). The Committee, under s. 91.48(1), Wis. Stats., along with the affected Town Board(s), under s. 17.36(4), have the authority to approve the application with integral conditions or to disapprove of the application. Having considered the entire record the Committee's recommendation is to:

By a vote of 6 in favor, 1 excused – (Manthei), the Committee recommended approval of this permit subject to the following ten (10) conditions:

1. Approval is granted for the extraction and sale of fill sand and bedding borrow materials only from this 7.37 acre site including the use of the existing 1.47 acre haul road;
2. A list of all haulers authorized to use this site shall be supplied to the Zoning, Planning & Land Information Department;
3. Hours of operation: 7am-6pm, Monday thru Friday;
4. The owner shall comply with all Non-Metallic Mining regulations for reclamation of site in conjunction with adjacent site;
5. An approved Erosion Control Permit is required;
6. There shall be no tracking on County Road B. If there is any spillage, it shall be cleaned up by the end of each work day;
7. All loads shall be covered before leaving the site;
8. Max of fifteen (15) truck loads per day;
9. No blasting allowed; and
10. This permit is non-transferable

Dated this 7th day of September 2011

ZONING, PLANNING AND LAND INFORMATION DEPARTMENT

BY Jeff Bluske
Jeff Bluske, Director

LA CROSSE COUNTY PLANNING, RESOURCES AND DEVELOPMENT COMMITTEE

BY Donald F Meyer
Donald F Meyer - Chair

THE COUNTY BOARD took the following action this 15th of September, 2011

Approved subject to conditions as outlined JB

Disapproved the application [Signature]

STATE OF WISCONSIN
COUNTY OF LA CROSSE

I, Ginny Dankmeyer, County Clerk of La Crosse County do hereby certify that this document is a true and correct copy of the original conditional use permit required by law to be in my custody and which the County Board of Supervisors of La Crosse County approved at a meeting held on the 15th day of September, 2011.

[Signature]
Ginny Dankmeyer, La Crosse County Clerk

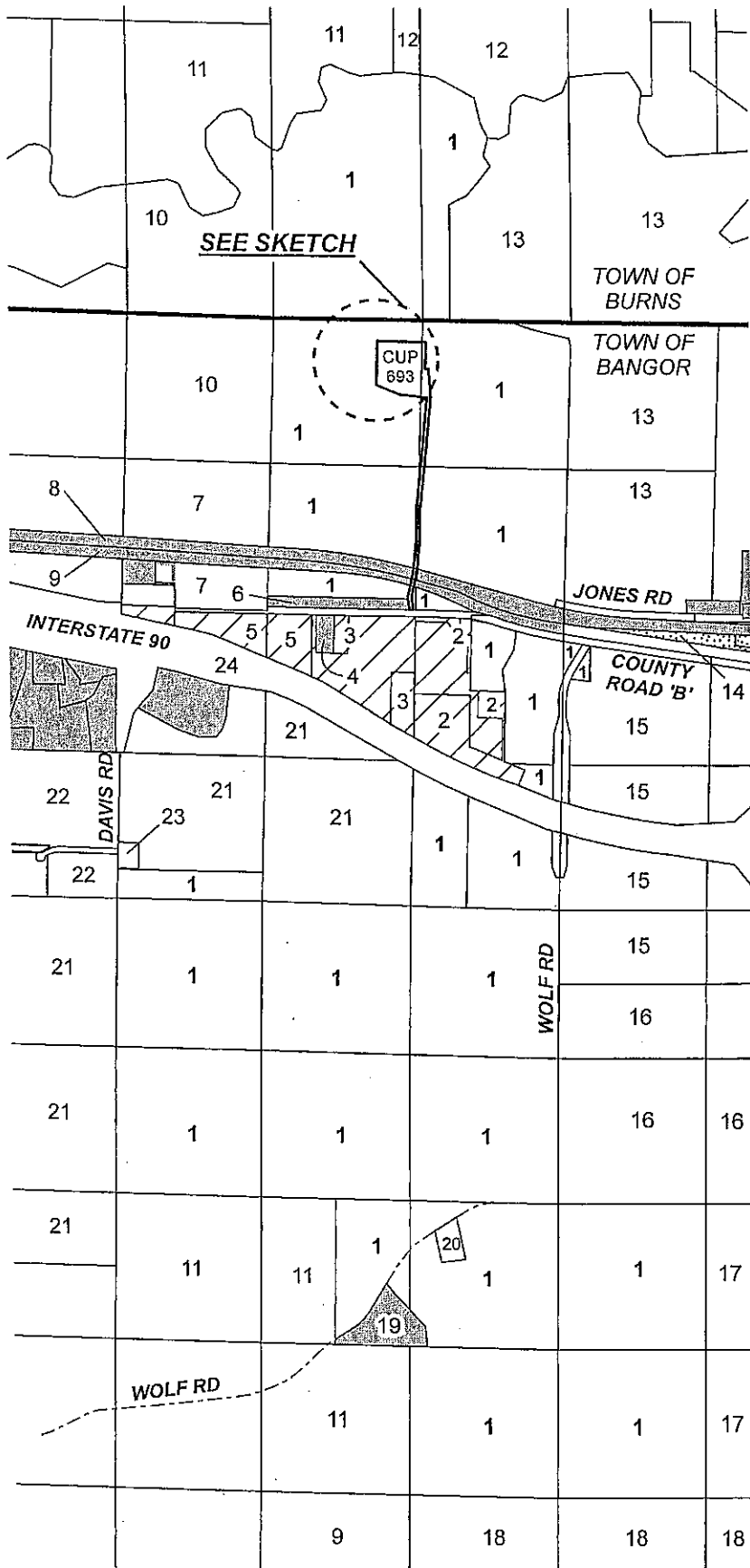
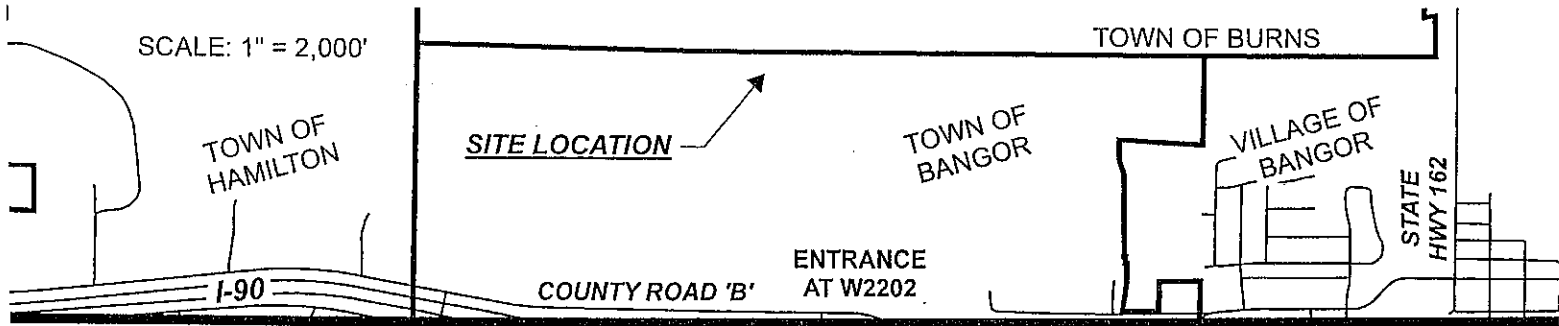

- 1 - F & D WOLF
- 2 - HOT-LINE TRUCKLOAD SERVICES LLC
- 3 - RDP INVESTMENTS LLC
- 4 - WERMEDAL
- 5 - COLLINS JOINT REVOCABLE LIVING TRUST
- 6 - HANSEN
- 7 - SEAB / TAUSCHER
- 8 - CP RAIL
- 9 - STATE OF WISCONSIN DNR
- 10 - SEAB
- 11 - KOTEK TRUST
- 12 - RHODES
- 13 - THE NICOLAI FAMILY TRUST
- 14 - PARISH
- 15 - KROENER FAMILY TRUST
- 16 - G & D WOLF REVOCABLE TRUST
- 17 - G & D WOLF TRUST
- 18 - ZURBUCHEN / HUTCH
- 19 - J & R WOLF
- 20 - KIMBALL
- 21 - KOLTERMANN
- 22 - JOHNSON
- 23 - WELLS
- 24 - STATE OF WISCONSIN DOT

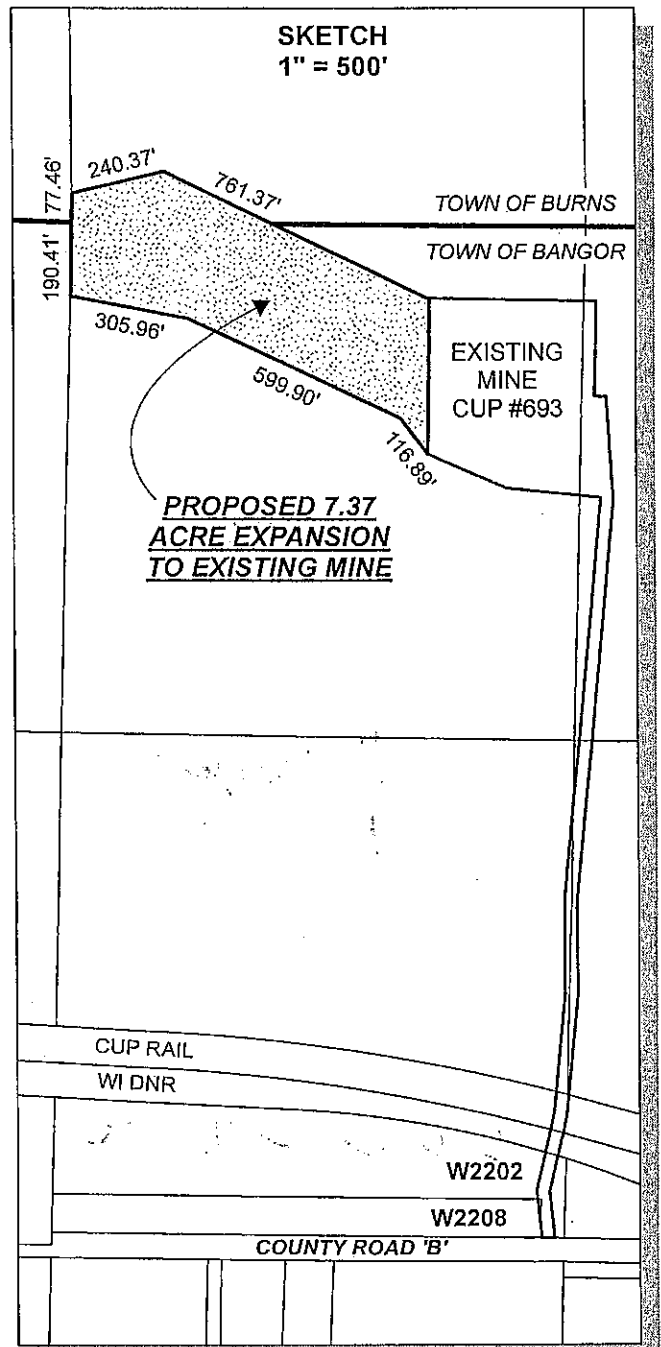

- AGRICULTURE 'A'
- COMMERCIAL 'B'
- EXCLUSIVE AG
- INDUSTRIAL

SCALE: 1" = 1,500'

CONDITIONAL USE PERMIT NO. 840

PART OF THE FRACTIONAL NW/NE, SECTION 6, T16N, R5W & PART OF GOV'T LOT 7, SECTION 31, T17N, R5W
TOWN OF BANGOR & TOWN OF BURNS