

CONDITIONAL USE PERMIT NO. 844

REPORT OF THE PLANNING, RESOURCES AND DEVELOPMENT COMMITTEE
TO THE COUNTY BOARD ON A HEARING FOR A CONDITIONAL USE PERMIT

TO THE COUNTY BOARD OF SUPERVISORS OF LA CROSSE COUNTY:

The La Crosse County Planning, Resources and Development Committee, having considered to application filed by:

JUSTIN PETERSON D/B/A CREAMERY CREEK HOLSTEINS, LLC, W1250 COUNTY ROAD U, BANGOR, WI 54614; ACTING ON BEHALF OF JOHN J & DONNA L HANSEN, 3420 KINNEY COULEE RD S, ONALASKA, WI 54650

and having held a public hearing on the 3rd day of October, 2011 for a Conditional Use Permit for a livestock facility expansion which includes a free-stall barn addition, a special needs barn, a manure transfer system and substantial barnyard run-off control practices in order to expand the number of animal units to a maximum of 683 on 265 acres of land zoned EXCLUSIVE AGRICULTURE DISTRICT in the Town of BANGOR and the Town of BURNS land described as follows:

That part of the NW ¼ of Section 3, T16N, R5W lying north of County Road U described in tax parcels 1-49-0; 1-50-0; 1-51-0 and 1-54-0, and that part of the NE-NE of Section 4, T16N, R5W, described in tax parcel 1-67-0 in the Town of Bangor; and Government Lots 7 & 8 in Section 33, T17N, R5W, described in tax parcels 3-702-0 & 3-704-0, and the SW-SW of Section 34, T17N, R5W in tax parcel 3-718-0 in the Town of Burns.

And pursuant to s. 59.69 Wis. Stats. and s. 17.36 Zoning Code: the Committee did publish and receive proof of a Class II notice of the hearing; did receive receipts of mailing of the notices to the affected Town Clerk(s); did hold a public hearing to hear testimony or correspondence from the people; and, did receive and consider action from the affected Town Board(s). The Committee, under s. 91.48(1), Wis. Stats., along with the affected Town Board(s), under s. 17.36(4), have the authority to approve the application with integral conditions or to disapprove of the application. Having considered the entire record the Committee's recommendation is to:

By unanimous vote, the Committee recommended approval of Conditional Use Permit No. 844 in accordance with the completed Wisconsin Department of Agriculture, Trade and Consumer Protection Chapter 51 application for a maximum of six hundred eighty-three (683) animal units.

Dated this 12th day of October 2011

ZONING, PLANNING AND LAND INFORMATION DEPARTMENT

BY

Jeff Bluske, Director

LA CROSSE COUNTY PLANNING, RESOURCES AND DEVELOPMENT COMMITTEE

BY

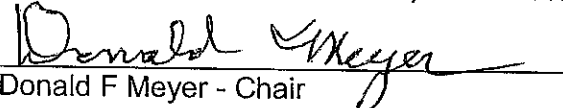
Donald F Meyer - Chair

THE COUNTY BOARD took the following action this 20th of October, 2011

Approved subject to conditions as outlined

Disapproved the application

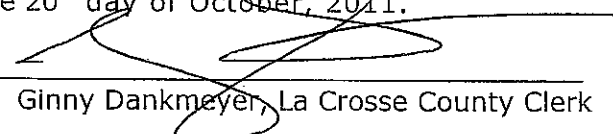

STATE OF WISCONSIN
COUNTY OF LA CROSSE

I, Ginny Dankmeyer, County Clerk of La Crosse County do hereby certify that this document is a true and correct copy of the original conditional use permit required by law to be in my custody and which the County Board of Supervisors of La Crosse County approved at a meeting held on the 20th day of October, 2011.

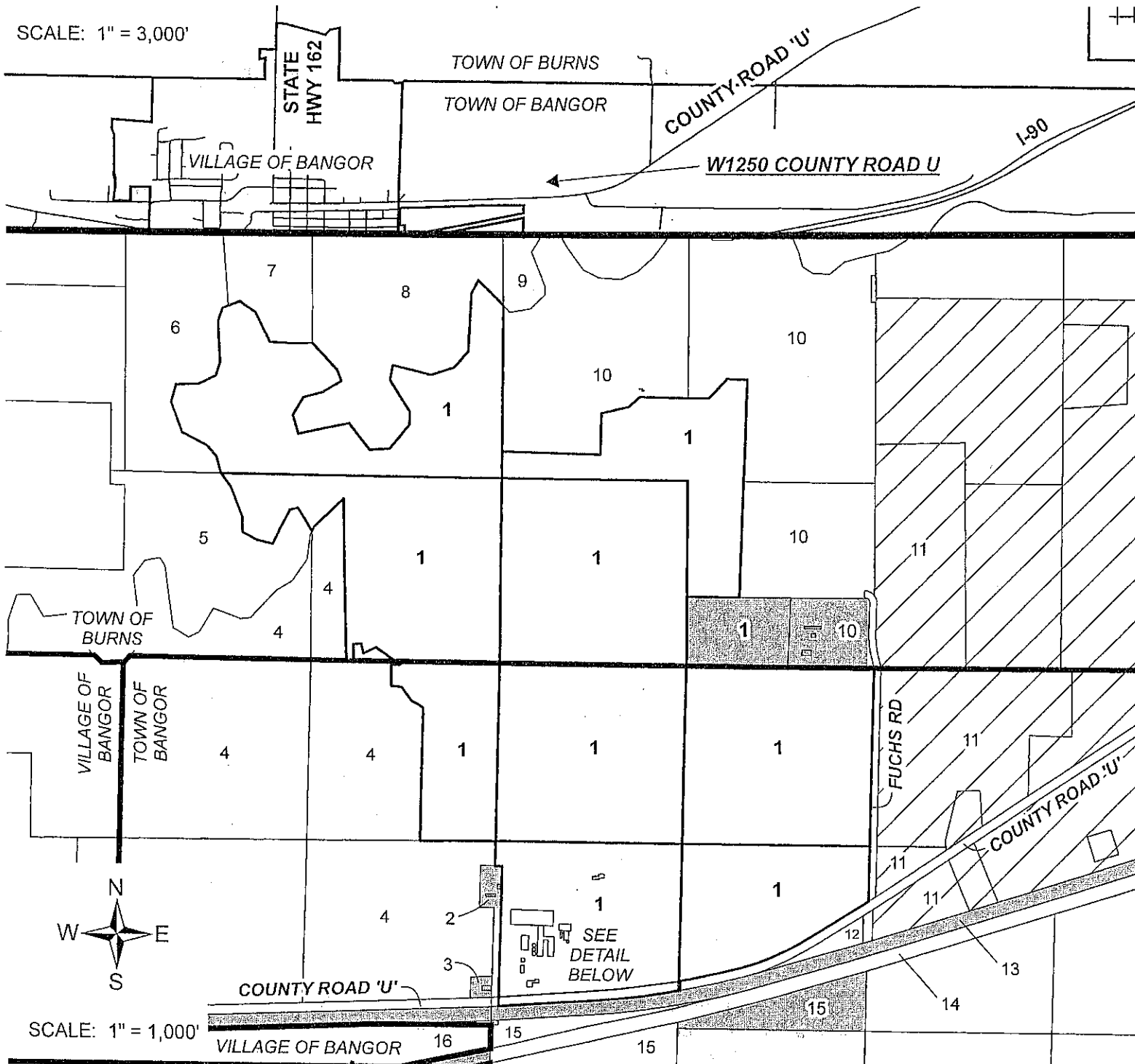

Ginny Dankmeyer, La Crosse County Clerk

SCALE: 1" = 3,000'

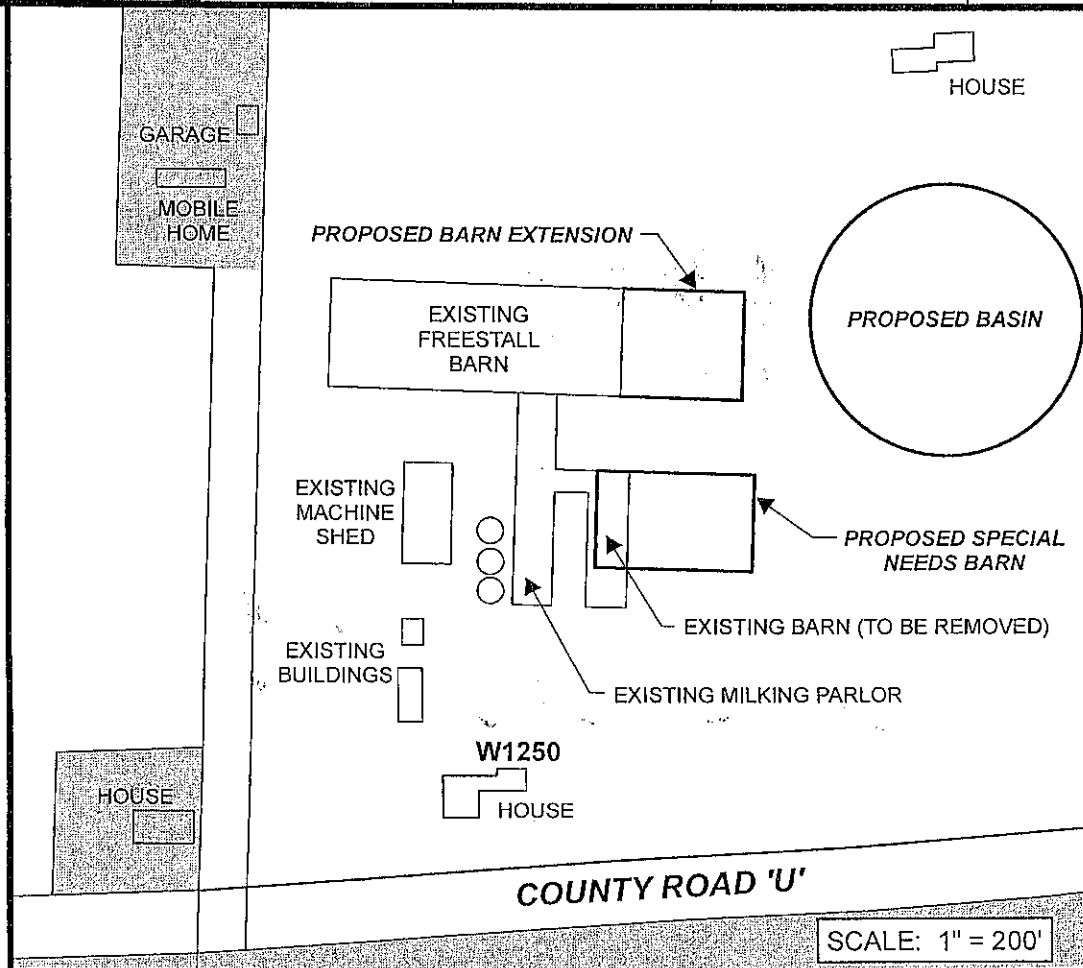

-  AGRICULTURAL DISTRICT 'A'
-  EXCLUSIVE AGRICULTURE
-  INDUSTRIAL DISTRICT

- 1 - J. & D. HANSEN
- 2 - D. & R. JEROME
- 3 - CLEMENTS
- 4 - BANGOR 1494 LAND LLC
- 5 - MILLER
- 6 - LUND
- 7 - DAVIS
- 8 - S. JEROME
- 9 - ZIMMER
- 10 - BORNTREGER
- 11 - STELLA-JONES CORPORATION
- 12 - L. & R. HANSEN
- 13 - CP RAIL
- 14 - STATE OF WISCONSIN DNR
- 15 - MANKE
- 16 - HANSLINE FARM LLC



**CONDITIONAL USE PERMIT NO. 844
ATCP 51 LIVESTOCK FACILITY SITING**

PART OF SECTIONS 3 & 4, T16N, R5W & PART OF SECTIONS 33 & 34, T17N, R5W
TOWN OF BANGOR & TOWN OF BURNS