

REPORT OF THE PLANNING, RESOURCES AND DEVELOPMENT COMMITTEE
TO THE COUNTY BOARD ON A HEARING FOR A CONDITIONAL USE PERMIT

TO THE COUNTY BOARD OF SUPERVISORS OF LA CROSSE COUNTY:

The La Crosse County Planning, Resources and Development Committee, having considered the application filed by:

**JUSTIN PETERSON A/K/A CREAMERY CREEK HOLSTEINS, LLC, W1250 COUNTY ROAD U,
BANGOR, WI 54614; ACTING ON BEHALF OF JOHN J & DONNA L HANSEN,
3420 KINNEY COULEE ROAD S, ONALASKA, WI 54650**

and having held a public hearing on the 29th day of NOVEMBER 2010 for a Conditional Use Permit for livestock facility expansion and after-the-fact animal unit expansion for up to 454 animal units including an approximate 110-ft X 124-ft barn expansion and implementation of barnyard runoff control practices on land zoned EXCLUSIVE AGRICULTURE DISTRICT in the Town of Burns

on land described as follows: That part of the NW ¼ of Section 3, T16N, R5W lying north of County Road U and described in tax parcels 1-49-0; 1-50-0; 1-51-0 & 1-54-0; and that part of the NE-NE of Section 4, T16N, R5W described in tax parcel 1-67-0 in the Town of Bangor; and, Government Lots 7 & 8 in Section 33, T17N, R5W described in tax parcels 3-702-0 & 3-704-0; and the SW-SW of Section 34, T17N, R5W in tax parcel 3-718-0 in the Town of Burns.

And pursuant to s. 59.69 Wis. Stats. and s. 17.36 Zoning Code: the Committee did publish and receive proof of a Class II notice of the hearing; did receive receipts of mailing of the notices to the affected Town Clerk(s); did hold a public hearing to hear testimony or correspondence from the people; and, did receive and consider action from the affected Town Board(s). The Committee and the affected Town Board(s), under s. 17.36(4), have the authority to approve the application with integral conditions or to disapprove of the application. Having considered the entire record the Committee's recommendation is to: **Approve with conditions.**

By unanimous vote, the Committee recommended approval of Conditional Use Permit No. 819 in accordance with the completed Wisconsin Department of Agriculture, Trade and Consumer Protection Chapter 51 rules.

Any deviation or alteration of the conditions set forth in this permit shall constitute a violation of the terms of this Conditional Use Permit and shall be subject to prosecution and penalties under the terms of this Ordinance. A new public hearing and permit must be granted to extend or alter any of the conditions set forth herein.

Dated this 8th day of DECEMBER 2010

ZONING, PLANNING AND LAND INFORMATION DEPARTMENT

BY 
Jeff Bluske, Director

LA CROSSE COUNTY PLANNING, RESOURCES AND DEVELOPMENT COMMITTEE

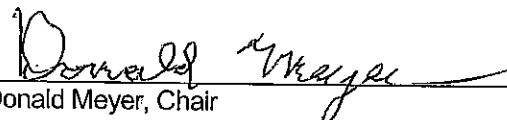
BY 
Donald Meyer, Chair

THE COUNTY BOARD took the following action this 16th day of DECEMBER, 2010

Approved subject to conditions as outlined

Disapproved the application

STATE OF WISCONSIN
COUNTY OF LA CROSSE

I, Linda A. Stone, County Clerk of La Crosse County do hereby certify that this document is a true and correct copy of the original conditional use permit required by law to be in my custody and which the County Board of Supervisors of La Crosse County approved at a meeting held on the 16th day of December, 2010.



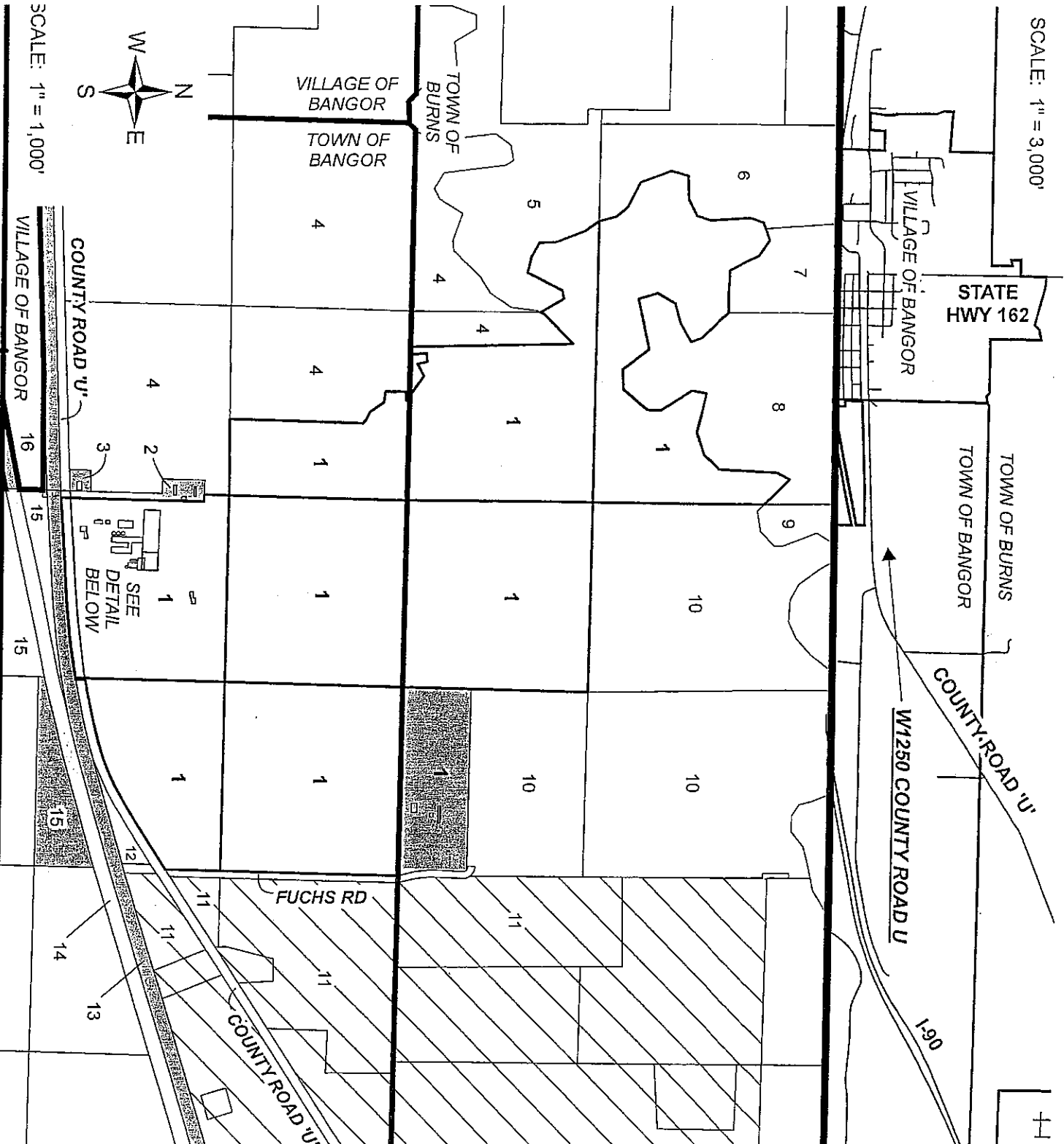

Linda A. Stone, La Crosse County Clerk

SCALE: 1" = 3,000'



SCALE: 1" = 1,000'



-  AGRICULTURAL DISTRICT 'A'
-  EXCLUSIVE AGRICULTURE
-  INDUSTRIAL DISTRICT

- 1- J. HANSEN
- 2- D. JEROME
- 3- CLEMENTS
- 4- NICOLAI
- 5- MILLER
- 6- LUND
- 7- DAVIS
- 8- S. JEROME
- 9- ZIMMER
- 10- BORNTRIEGER
- 11- STELLA-JONES CORPORATION
- 12- L. HANSEN
- 13- CP RAIL
- 14- STATE OF WISCONSIN DNR
- 15- MANKIE
- 16- MOL-CO INC

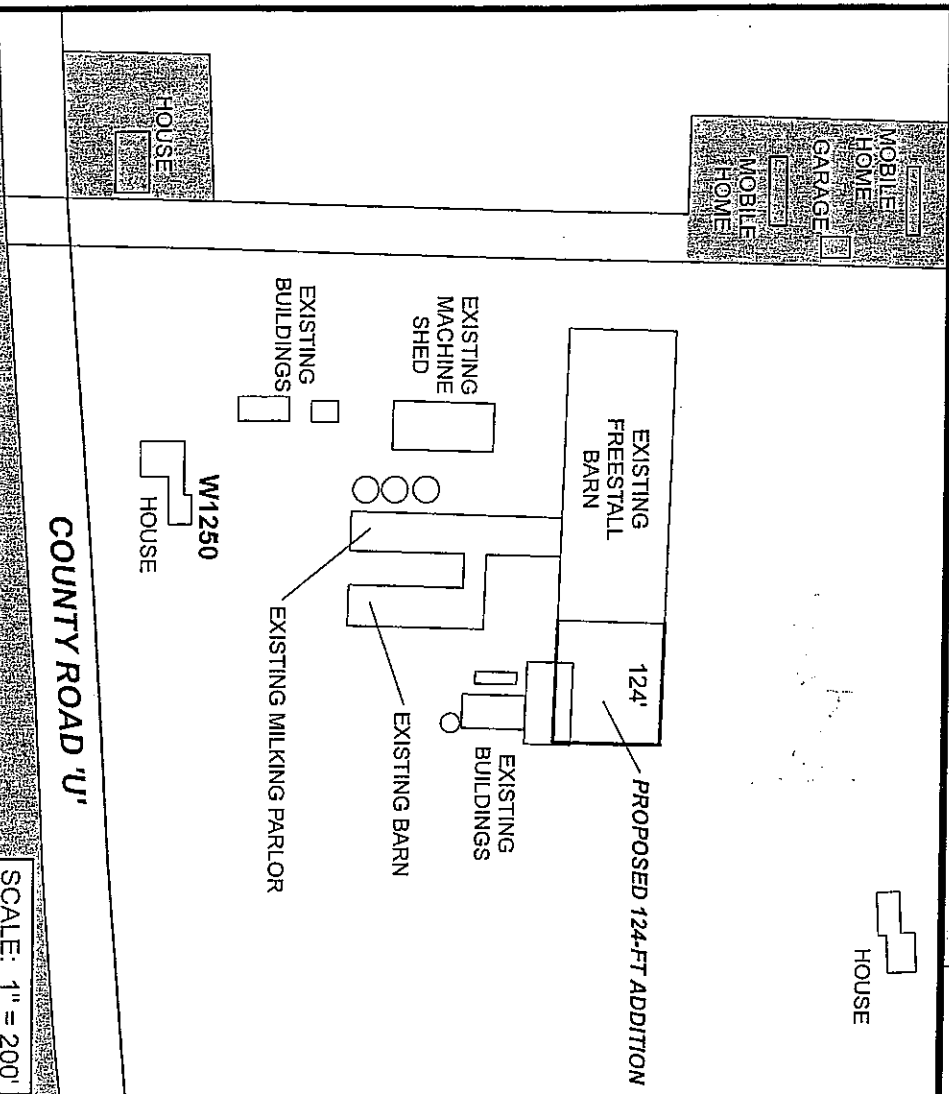

SCALE: 1" = 200'

CONDITIONAL USE PERMIT NO. 819
ATCP 51 LIVESTOCK FACILITY SITING
 PART OF SECTIONS 3 & 4, T16N, R5W & PART OF SECTIONS 33 & 34, T17N, R5W
 TOWN OF BANGOR & TOWN OF BURNS
 JUSTIN PETERSON, CREAMERY CREEK HOLSTEINS, LLC, O.B.O. JOHN J. & DONNA L. HANSEN