

TERMINATION OF CONDITIONAL USE PERMIT NO. 54 - TERMINATION NO. 44

REPORT OF THE PLANNING, RESOURCES AND DEVELOPMENT COMMITTEE  
TO THE COUNTY BOARD ON A HEARING FOR TERMINATION OF A CONDITIONAL USE PERMIT

TO THE COUNTY BOARD OF SUPERVISORS OF LA CROSSE COUNTY:

The La Crosse County Planning, Resources and Development Committee, having considered the application filed by:

LA CROSSE COUNTY ZONING, PLANNING AND LAND INFORMATION DEPARTMENT  
400 4<sup>TH</sup> ST N - ROOM 3170 LA CROSSE WI 54601

and having held a public hearing on the 30<sup>th</sup> day of March, 2009 on a petition to terminate Conditional Use Permit No. 54 issued to Robert & Carol Kasparek, current owners James & Dawn Gorniak, W3113 Old Highway 16, West Salem, WI and passed by the County Board on April 14, 1983, to operate a craft and gift shop in the granary. Reason for terminating - the business has not operated for the past 12 consecutive months.

**LAND DESCRIBED AS:** Lots 1 & 2 of Certified Survey Map No. 191, Volume 1 in the Town of Onalaska.

And pursuant to s. 59.69 Wis. Stats. and s. 17.36 Zoning Code: the Committee did publish and receive proof of a Class II notice of the hearing; did receive receipts of mailing of the notices to the affected Town Clerk(s); did hold a public hearing to hear testimony or correspondence from the people; and, did receive and consider action from the affected Town Board(s). The Committee and the affected Town Board(s), under s. 17.36(4), have the authority to approve the application with integral conditions or to disapprove of the application. Having considered the entire record the Committee's recommendation is to: **Terminate.**

**By a vote of 4 in favor, 3 - excused (Meyer, Manthei, Mach), the Committee recommends terminating Conditional Use Permit No. 54 because this business has not operated from this site for more than the past 12 consecutive months.**

Dated this 8<sup>th</sup> day of April, 2009

ZONING, PLANNING AND LAND INFORMATION DEPARTMENT

BY   
Jeff Bluske, Director  
Zoning, Planning and Land Information Department

LA CROSSE COUNTY PLANNING, RESOURCES AND DEVELOPMENT COMMITTEE

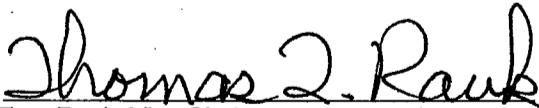
BY   
Tom Rauk, Vice Chairman

THE COUNTY BOARD took the following action this 21 day of April 2009

Approved termination

STATE OF WISCONSIN  
COUNTY OF LA CROSSE

I, Linda A. Stone, County Clerk of La Crosse County do hereby certify that this document is a true and correct copy of the original Termination of a Conditional Use Permit required by law to be in my custody and which the County Board of Supervisors of La Crosse County approved at a meeting held on the 21<sup>st</sup> day of April 2009.

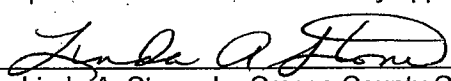
  
Linda A. Stone, La Crosse County Clerk

TRANSITIONAL AGRICULTURE

TRANSITIONAL AGRICULTURE

GILSTER

NESHONOC HEIGHTS ADD.  
RES. "A."

OLD

HIGHWAY

"16"

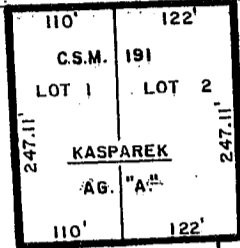

OSTRANDER

AG. "A."

AG. "A"

MARTELL

TRANS.

"AG."

AG. "A"

MILLARD

AG. "A."

"16"

S. T. H.

# CONDITIONAL USE APPLICATION NO. 54

LOTS 1 & 2, CERTIFIED SURVEY MAP VOL. 1,  
PAGE 191, LOCATED IN THE SE 1/4 OF THE SW 1/4  
AND THE SW 1/4 OF THE SE 1/4 OF SEC. 26,  
T 17 N, R 6 W, TOWN OF HAMILTON.

APPLICATION BY ROBERT & CAROL KASPAREK.